

# IMPORT PRICE LIST

## **C153 DI COMPACT MJ FITTINGS**

### **ANSI/AWWA C153/A21.53**

version: **IMP-UPL.19.01**  
EFFECTIVE: JANUARY 14, 2019  
(SUPERSEDES ALL PREVIOUS PRICING)

#### **WEST COAST (U.S.)**

Toll Free: (877) 701-7827  
Fax: (951) 898-9561

#### **CENTRAL (U.S.)**

Toll Free: (800) 999-3009  
Fax: (281) 558-9000

#### **CAMBRIDGE (CANADA)**

Toll Free: (888) 893-7827  
Fax: (519) 650-1553



Certified to  
ISO 9001:2015

Star Pipe Products  
4018 Westhollow Parkway  
Houston, Texas 77082  
[www.starpipeproducts.com](http://www.starpipeproducts.com)

Corporate Headquarters  
800.999.3009 Toll Free  
281.558.3000 Telephone  
281.558.9000 Fax



IMP-UPL.19.01

Size (inches)	Item Code Cement Lined w/ Black Coating	Item Code Bare In / Bare Out	Less Accessory List Price	Weight* (lbs.)	Crate Quantity
---------------	---	------------------------------	---------------------------	----------------	----------------

**90° (1/4) MJ BEND**

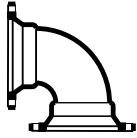

(SEE C110 MJ)					
2	MJB9002	MJB9002U			
3	MJB9003	MJB9003U	\$92.00	16	80
4	MJB9004	MJB9004U	\$99.00	25	80
6	MJB9006	MJB9006U	\$162.00	39	36
8	MJB9008	MJB9008U	\$235.00	57	18
10	MJB9010	MJB9010U	\$373.00	89	8
12	MJB9012	MJB9012U	\$502.00	108	8
14	MJB9014	MJB9014U	\$838.00	210	2
16	MJB9016	MJB9016U	\$1,137.00	264	2
18	MJB9018	MJB9018U	\$1,369.00	335	
20	MJB9020	MJB9020U	\$1,908.00	400	
24	MJB9024	MJB9024U	\$2,848.00	565	
30	MJB9030	MJB9030U	\$4,570.00	930	
36	MJB9036	MJB9036U	\$7,144.00	1450	
42	MJB9042	MJB9042U	\$12,249.00	2205	
48	MJB9048	MJB9048U	\$16,332.00	2990	

**60° (1/6) MJ BEND**

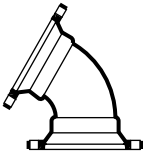

30	MJB6030	MJB6030U	POA		
36	MJB6036	MJB6036U	POA		
42	MJB6042	MJB6042U	POA		
48	MJB6048	MJB6048U	POA		

**45° (1/8) MJ BEND**



(SEE C110 MJ)					
2	MJB4502	MJB4502U			
3	MJB4503	MJB4503U	\$82.00	16	80
4	MJB4504	MJB4504U	\$82.00	22	80
6	MJB4506	MJB4506U	\$132.00	32	36
8	MJB4508	MJB4508U	\$192.00	46	27
10	MJB4510	MJB4510U	\$278.00	70	8
12	MJB4512	MJB4512U	\$415.00	86	8
14	MJB4514	MJB4514U	\$652.00	160	8
16	MJB4516	MJB4516U	\$813.00	202	4
18	MJB4518	MJB4518U	\$1,166.00	250	2
20	MJB4520	MJB4520U	\$1,244.00	305	
24	MJB4524	MJB4524U	\$1,890.00	405	
30	MJB4530	MJB4530U	\$3,839.00	780	
36	MJB4536	MJB4536U	\$5,613.00	1135	
42	MJB4542	MJB4542U	\$8,622.00	1610	
48	MJB4548	MJB4548U	\$11,297.00	2090	

**30° (1/12) MJ BEND**



30	MJB3030	MJB3030U	POA		
36	MJB3036	MJB3036U	POA		
42	MJB3042	MJB3042U	POA		
48	MJB3048	MJB3048U	POA		



IMP-UPL.19.01

Size (inches)	Item Code Cement Lined w/ Black Coating	Item Code Bare In / Bare Out	Less Accessory List Price	Weight* (lbs.)	Crate Quantity
---------------	---	------------------------------	---------------------------	----------------	----------------

**22 1/2° (1/16) MJ BEND**



2	MJB2202	MJB2202U	\$94.00	9	
3	MJB2203	MJB2203U	\$52.00	15	50
4	MJB2204	MJB2204U	\$78.00	18	100
6	MJB2206	MJB2206U	\$120.00	31	48
8	MJB2208	MJB2208U	\$187.00	46	36
10	MJB2210	MJB2210U	\$277.00	64	12
12	MJB2212	MJB2212U	\$363.00	80	12
14	MJB2214	MJB2214U	\$660.00	136	8
16	MJB2216	MJB2216U	\$780.00	172	4
18	MJB2218	MJB2218U	\$957.00	255	2
20	MJB2220	MJB2220U	\$1,300.00	310	2
24	MJB2224	MJB2224U	\$1,745.00	412	2
30	MJB2230	MJB2230U	\$3,217.00	665	
36	MJB2236	MJB2236U	\$4,715.00	960	
42	MJB2242	MJB2242U	\$7,117.00	1350	
48	MJB2248	MJB2248U	\$9,267.00	1760	

**11 1/4° (1/32) MJ BEND**



2	MJB1102	MJB1102U	\$116.00	8	30
3	MJB1103	MJB1103U	\$60.00	14	30
4	MJB1104	MJB1104U	\$75.00	16	50
6	MJB1106	MJB1106U	\$125.00	30	60
8	MJB1108	MJB1108U	\$170.00	42	36
10	MJB1110	MJB1110U	\$275.00	58	12
12	MJB1112	MJB1112U	\$340.00	67	12
14	MJB1114	MJB1114U	\$753.00	93	8
16	MJB1116	MJB1116U	\$825.00	148	4
18	MJB1118	MJB1118U	\$1,209.00	205	2
20	MJB1120	MJB1120U	\$1,224.00	245	2
24	MJB1124	MJB1124U	\$1,634.00	315	2
30	MJB1130	MJB1130U	\$3,275.00	600	
36	MJB1136	MJB1136U	\$4,476.00	820	
42	MJB1142	MJB1142U	\$6,793.00	1180	
48	MJB1148	MJB1148U	\$9,204.00	1475	

**5 5/8° (1/64) MJ BEND**

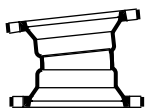

3	MJB0503	MJB0503U	\$92.00		
4	MJB0504	MJB0504U	\$110.00	16	
6	MJB0506	MJB0506U	\$187.00	27	
8	MJB0508	MJB0508U	\$255.00	38	
10	MJB0510	MJB0510U	\$412.00	56	
12	MJB0512	MJB0512U	\$510.00	73	
14	MJB0514	MJB0514U	\$1,129.00		
16	MJB0516	MJB0516U	\$1,236.00	150	
18	MJB0518	MJB0518U	\$1,813.00		
20	MJB0520	MJB0520U	\$1,835.00	239	
24	MJB0524	MJB0524U	\$2,664.00	317	
30	MJB0530	MJB0530U	\$4,696.00	568	
36	MJB0536	MJB0536U	\$7,319.00	825	
42	MJB0542	MJB0542U	\$12,796.00	1125	
48	MJB0548	MJB0548U	\$17,059.00	1600	

\*Weights exclude accessories





IMP-UPL.19.01

Size (inches)	Item Code Cement Lined w/ Black Coating	Item Code Bare In / Bare Out	Less Accessory List Price	Weight* (lbs.)	Crate Quantity
---------------	---	------------------------------	---------------------------	----------------	----------------

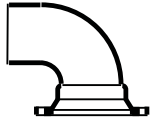

**90° (1/4) MJ X PE BEND**

3	MJBP9003	MJBP9003U	\$90.00	16	80
4	MJBP9004	MJBP9004U	\$118.00	22	32
6	MJBP9006	MJBP9006U	\$195.00	41	24
8	MJBP9008	MJBP9008U	\$278.00	58	9
10	MJBP9010	MJBP9010U	\$436.00	83	4
12	MJBP9012	MJBP9012U	\$569.00	114	4
14	MJBP9014	MJBP9014U	\$985.00	197	
16	MJBP9016	MJBP9016U	\$1,509.00	248	2
18	MJBP9018	MJBP9018U	\$2,614.00	325	
20	MJBP9020	MJBP9020U	\$2,925.00	390	
24	MJBP9024	MJBP9024U	\$3,139.00	575	
30	MJBP9030	MJBP9030U	\$5,059.00	865	
36	MJBP9036	MJBP9036U	\$11,390.00		
42	MJBP9042	MJBP9042U	\$11,518.00		
48	MJBP9048	MJBP9048U	\$22,055.00		



**45° (1/8) MJ X PE BEND**

3	MJBP4503	MJBP4503U	\$77.00	13	
4	MJBP4504	MJBP4504U	\$87.00	19	48
6	MJBP4506	MJBP4506U	\$147.00	34	24
8	MJBP4508	MJBP4508U	\$234.00	49	24
10	MJBP4510	MJBP4510U	\$346.00	69	12
12	MJBP4512	MJBP4512U	\$493.00	93	8
14	MJBP4514	MJBP4514U	\$800.00	146	
16	MJBP4516	MJBP4516U	\$920.00	184	2
18	MJBP4518	MJBP4518U	\$2,160.00	235	2
20	MJBP4520	MJBP4520U	\$2,197.00	290	
24	MJBP4524	MJBP4524U	\$2,129.00	390	
30	MJBP4530	MJBP4530U	\$4,183.00	715	
36	MJBP4536	MJBP4536U	\$10,392.00		
42	MJBP4542	MJBP4542U	\$10,684.00	1460	
48	MJBP4548	MJBP4548 U	\$13,494.00	2235	



**22 1/2° (1/16) MJ X PE BEND**

3	MJBP2203	MJBP2203U	\$66.00	12	
4	MJBP2204	MJBP2204U	\$89.00	18	32
6	MJBP2206	MJBP2206U	\$153.00	29	20
8	MJBP2208	MJBP2208U	\$234.00	43	20
10	MJBP2210	MJBP2210U	\$312.00	61	18
12	MJBP2212	MJBP2212U	\$413.00	79	6
14	MJBP2214	MJBP2214U	\$828.00	133	
16	MJBP2216	MJBP2216U	\$1,274.00	166	
18	MJBP2218	MJBP2218U	\$1,444.00	235	
20	MJBP2220	MJBP2220U	\$2,064.00	300	
24	MJBP2224	MJBP2224U	\$2,927.00	395	
30	MJBP2230	MJBP2230U	\$3,508.00	600	
36	MJBP2236	MJBP2236U	POA	865	
42	MJBP2242	MJBP2242U	POA	1200	
48	MJBP2248	MJBP2248U	POA		



IMP-UPL.19.01

Size (inches)	Item Code Cement Lined w/ Black Coating	Item Code Bare In / Bare Out	Less Accessory List Price	Weight* (lbs.)	Crate Quantity
<b>11 1/4° (1/32) MJ X PE BEND</b>					
3	MJBP1103	MJBP1103U	\$66.00	12	40
4	MJBP1104	MJBP1104U	\$86.00	17	
6	MJBP1106	MJBP1106U	\$142.00	27	60
8	MJBP1108	MJBP1108U	\$220.00	39	36
10	MJBP1110	MJBP1110U	\$278.00	52	24
12	MJBP1112	MJBP1112U	\$358.00	69	16
14	MJBP1114	MJBP1114U	\$667.00	118	
16	MJBP1116	MJBP1116U	\$826.00	136	
18	MJBP1118	MJBP1118U	\$1,444.00	235	
20	MJBP1120	MJBP1120U	\$2,064.00	300	
24	MJBP1124	MJBP1124U	\$2,927.00	400	
30	MJBP1130	MJBP1130U	\$7,336.00	535	
42	MJBP1142	MJBP1142U	\$14,276.00		



**90° (1/4) MJ X FE BEND**

3	MJFB9003	MJFB9003U	\$100.00	20	32
4	MJFB9004	MJFB9004U	\$113.00	26	48
6	MJFB9006	MJFB9006U	\$200.00	47	27
8	MJFB9008	MJFB9008U	\$347.00	68	12
10	MJFB9010	MJFB9010U	\$567.00	102	8
12	MJFB9012	MJFB9012U	\$815.00	134	4
14	MJFB9014	MJFB9014U	\$1,374.00	227	
16	MJFB9016	MJFB9016U	\$1,673.00	306	
24	MJFB9024	MJFB9024U	\$4,634.00	617	
30	MJFB9030	MJFB9030U	\$8,129.00	1014	



**45° (1/8) MJ X FE BEND**

3	MJFB4503	MJFB4503U	\$119.00	17	32
4	MJFB4504	MJFB4504U	\$123.00	26	40
6	MJFB4506	MJFB4506U	\$180.00	47	12
8	MJFB4508	MJFB4508U	\$346.00	68	12
10	MJFB4510	MJFB4510U	\$507.00	102	4
12	MJFB4512	MJFB4512U	\$757.00	134	4
14	MJFB4514	MJFB4514U	\$1,133.00	207	
16	MJFB4516	MJFB4516U	\$1,555.00	239	
24	MJFB4524	MJFB4524U	\$3,316.00	463	2
30	MJFB4530	MJFB4530U	\$14,504.00		



**22 1/2° (1/16) MJ X FE BEND**

3	MJFB2203	MJFB2203U	\$206.00	17	24
4	MJFB2204	MJFB2204U	\$158.00	26	32
6	MJFB2206	MJFB2206U	\$202.00	47	48
8	MJFB2208	MJFB2208U	\$312.00	68	9
10	MJFB2210	MJFB2210U	\$454.00	102	4
12	MJFB2212	MJFB2212U	\$662.00	134	4
30	MJFB2230	MJFB2230U	\$13,553.00		





IMP-UPL.19.01

Size (inches)	Item Code Cement Lined w/ Black Coating	Item Code Bare In / Bare Out	Less Accessory List Price	Weight* (lbs.)	Crate Quantity
---------------	---	------------------------------------	---------------------------------	-------------------	-------------------

**11 1/4° (1/32) MJ X FE BEND**



4	MJFB1104	MJFB1104U	\$138.00	19	16
6	MJFB1106	MJFB1106U	\$195.00	30	18
8	MJFB1108	MJFB1108U	\$258.00	50	18
10	MJFB1110	MJFB1110U	\$436.00	75	
12	MJFB1112	MJFB1112U	\$569.00	88	6

**MJ LATERAL**

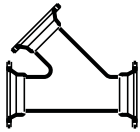

3x3	MJL0303	MJL0303U	\$170.00	36	30
4x2	MJL0402	MJL0403U	\$383.00		
4x3	MJL0403	MJL0403U	\$187.00	40	30
4x4	MJL0404	MJL0404U	\$213.00	51	30
6x4	MJL0604	MJL0604U	\$218.00	73	12
6x6	MJL0606	MJL0606U	\$319.00	81	6
8x4	MJL0804	MJL0804U	\$440.00	106	6
8x6	MJL0806	MJL0806U	\$369.00	114	6
8x8	MJL0808	MJL0808U	\$465.00	128	6
10x4	MJL1004	MJL1004U	\$740.00	150	4
10x6	MJL1006	MJL1006U	\$778.00	136	4
10x8	MJL1008	MJL1008U	\$847.00	170	4
10x10	MJL1010	MJL1010U	\$1,034.00	199	4
12x4	MJL1204	MJL1204U	\$1,056.00	184	2
12x6	MJL1206	MJL1206U	\$1,098.00	186	2
12x8	MJL1208	MJL1208U	\$1,179.00	188	2
12x10	MJL1210	MJL1210U	\$1,385.00	250	2
12x12	MJL1212	MJL1212U	\$1,230.00	272	2
14x06	MJL1406	MJL1406U	\$2,023.00	380	2
14x08	MJL1408	MJL1408U	\$4,194.00	300	2
14x10	MJL1410	MJL1410U	\$2,093.00		
14x14	MJL1414	MJL1414U	\$2,233.00	474	2
16x6	MJL1606	MJL1606U	\$1,488.00	300	2
16x8	MJL1608	MJL1608U	\$1,745.00	349	2
16x10	MJL1610	MJL1610U	\$3,357.00	496	2
16x12	MJL1612	MJL1612U	\$2,238.00	453	
16x16	MJL1616	MJL1616U	\$2,722.00	575	2

\*\*\* FULL BODY ONLY 18" AND HIGHER \*\*\*

**MJ X FE ADAPTER**

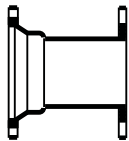

3	MJFA03	MJFA03U	\$82.00	14	75
4	MJFA04	MJFA04U	\$94.00	21	100
6	MJFA06	MJFA06U	\$130.00	28	45
8	MJFA08	MJFA08U	\$196.00	49	45
10	MJFA10	MJFA10U	\$340.00	60	20
12	MJFA12	MJFA12U	\$436.00	99	20
14	MJFA14	MJFA14U	\$692.00	150	8
16	MJFA16	MJFA16U	\$790.00	186	8
18	MJFA18	MJFA18U	\$1,208.00	222	2
20	MJFA20	MJFA20U	\$1,438.00	252	2
24	MJFA24	MJFA24U	\$1,770.00	324	2
30	MJFA30	MJFA30U	\$3,258.00	544	
36	MJFA36	MJFA36U	\$4,667.00	798	
42	MJFA42	MJFA42U	\$12,794.00	1214	
48	MJFA48	MJFA48U	\$15,356.00	1600	



IMP-UPL.19.01

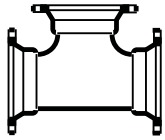

Size (inches)	Item Code Cement Lined w/ Black Coating	Item Code Bare In / Bare Out	Less Accessory List Price	Weight* (lbs.)	Crate Quantity
<b>MJ TEE</b>					
2x2	MJT0202	MJT0202U		<b>(SEE C110 MJ)</b>	
3x2	MJT0302	MJT0302U	\$220.00		
3x3	MJT0303	MJT0303U	\$122.00	28	50
4x2	MJT0402	MJT0402U	\$195.00	29	24
4x3	MJT0403	MJT0403U	\$148.00	30	16
4x4	MJT0404	MJT0404U	\$130.00	32	32
6x3	MJT0603	MJT0603U	\$179.00	42	12
6x4	MJT0604	MJT0604U	\$217.00	46	24
6x4x6	MJT060406	MJT060406U	\$524.00	60	12
6x6	MJT0606	MJT0606U	\$234.00	56	24
6x6x8	MJT060608	MJT060608U	\$459.00	75	18
8x3	MJT0803	MJT0803U	\$285.00	52	9
8x4	MJT0804	MJT0804U	\$253.00	60	18
8x6	MJT0806	MJT0806U	\$290.00	72	18
8x6x6	MJT080606	MJT080606U	\$732.00	75	9
8x6x8	MJT080608	MJT080608U	\$732.00	85	9
8x8	MJT0808	MJT0808U	\$350.00	86	18
10x3	MJT1003	MJT1003U	\$372.00	75	6
10x4	MJT1004	MJT1004U	\$386.00	78	8
10x6	MJT1006	MJT1006U	\$374.00	90	8
10x8	MJT1008	MJT1008U	\$438.00	105	12
10x10	MJT1010	MJT1010U	\$500.00	120	4
12x3	MJT1203	MJT1203U	\$506.00	90	
12x4	MJT1204	MJT1204U	\$473.00	94	8
12x6	MJT1206	MJT1206U	\$473.00	110	8
12x8	MJT1208	MJT1208U	\$545.00	125	8
12x10	MJT1210	MJT1210U	\$700.00	140	4
12x12	MJT1212	MJT1212U	\$698.00	160	4
14x6	MJT1406	MJT1406U	\$754.00	182	4
14x8	MJT1408	MJT1408U	\$854.00	206	4
14x10	MJT1410	MJT1410U	\$1,139.00	228	4
14x12	MJT1412	MJT1412U	\$1,224.00	234	4
14x14	MJT1414	MJT1414U	\$1,159.00	280	4
16x4	MJT1604	MJT1604U	\$1,793.00		
16x6	MJT1606	MJT1606U	\$973.00	228	2
16x8	MJT1608	MJT1608U	\$1,056.00	248	2
16x10	MJT1610	MJT1610U	\$1,398.00	264	2
16x12	MJT1612	MJT1612U	\$1,263.00	280	2
16x14	MJT1614	MJT1614U	\$1,724.00	316	2
16x16	MJT1616	MJT1616U	\$1,594.00	322	2
18x4	MJT1804	MJT1804U	\$2,496.00	271	4
18x6	MJT1806	MJT1806U	\$1,377.00	275	
18x8	MJT1808	MJT1808U	\$1,492.00	295	
18x10	MJT1810	MJT1810U	\$1,525.00	315	
18x12	MJT1812	MJT1812U	\$1,770.00	335	
18x14	MJT1814	MJT1814U	\$2,289.00	380	
18x16	MJT1816	MJT1816U	\$2,390.00	405	
18x18	MJT1818	MJT1818U	\$2,305.00	435	
20x6	MJT2006	MJT2006U	\$1,549.00	315	
20x8	MJT2008	MJT2008U	\$1,584.00	345	
20x10	MJT2010	MJT2010U	\$2,144.00	370	
20x12	MJT2012	MJT2012U	\$1,960.00	395	



# C153 Ductile Iron Compact Mechanical Joint Fittings

Price List  
**MJ COMPACT**

IMP-UPL.19.01

Size (inches)	Item Code Cement Lined w/ Black Coating	Item Code Bare In / Bare Out	Less Accessory List Price	Weight* (lbs.)	Crate Quantity
20x14	MJT2014	MJT2014U	\$2,450.00	440	
20x16	MJT2016	MJT2016U	\$1,929.00	465	
20x18	MJT2018	MJT2018U	\$3,149.00	505	
20x20	MJT2020	MJT2020U	\$2,125.00	535	
24x6	MJT2406	MJT2406U	\$1,864.00	415	
24x8	MJT2408	MJT2408U	\$1,887.00	445	
24x10	MJT2410	MJT2410U	\$2,534.00	470	
24x12	MJT2412	MJT2412U	\$2,192.00	500	
24x14	MJT2414	MJT2414U	\$3,003.00	550	
24x16	MJT2416	MJT2416U	\$2,760.00	580	
24x18	MJT2418	MJT2418U	\$3,189.00	625	
24x20	MJT2420	MJT2420U	\$3,540.00	660	
24x24	MJT2424	MJT2424U	\$3,153.00	720	
30x4	MJT3004	MJT3004U	\$4,883.00		
30x6	MJT3006	MJT3006U	\$3,166.00	742	
30x8	MJT3008	MJT3008U	\$3,573.00	739	
30x10	MJT3010	MJT3010U	\$6,308.00		
30x12	MJT3012	MJT3012U	\$4,012.00	830	
30x16	MJT3016	MJT3016U	\$4,636.00	959	
30x18	MJT3018	MJT3018U	\$6,948.00	1085	
30x20	MJT3020	MJT3020U	\$4,903.00	995	
30x24	MJT3024	MJT3024U	\$5,127.00	1060	
30x30	MJT3030	MJT3030U	\$6,609.00	1323	
36x6	MJT3606	MJT3606U	\$6,432.00	1000	
36x8	MJT3608	MJT3608U	\$6,142.00	1050	
36x10	MJT3610	MJT3610U	\$5,334.00		
36x12	MJT3612	MJT3612U	\$5,334.00	1150	
36x16	MJT3616	MJT3616U	\$5,755.00	1167	
36x18	MJT3618	MJT3618U	\$10,623.00	1505	
36x20	MJT3620	MJT3620U	\$10,623.00	1520	
36x24	MJT3624	MJT3624U	\$7,276.00	1498	
36x30	MJT3630	MJT3630U	\$8,099.00	1555	
36x36	MJT3636	MJT3636U	\$9,590.00	1900	
42x6	MJT4206	MJT4206U	\$12,732.00	1800	
42x8	MJT4208	MJT4208U	\$12,314.00		
42x12	MJT4212	MJT4212U	\$13,717.00	1950	
42x16	MJT4216	MJT4216U	\$12,720.00	2040	
42x18	MJT4218	MJT4218U	\$14,747.00	2195	
42x20	MJT4220	MJT4220U	\$14,747.00	2235	
42x24	MJT4224	MJT4224U	\$11,806.00	2270	
42x30	MJT4230	MJT4230U	\$12,023.00	2425	
42x36	MJT4236	MJT4236U	\$15,366.00	3000	
42x42	MJT4242	MJT4242U	\$16,298.00	3175	
48x6	MJT4806	MJT4806U	\$21,182.00	2155	
48x8	MJT4808	MJT4808U	\$22,127.00		
48x12	MJT4812	MJT4812U	\$15,587.00	2130	
48x16	MJT4816	MJT4816U	\$21,116.00	2650	
48x18	MJT4818	MJT4818U	\$21,116.00		
48x20	MJT4820	MJT4820U	\$21,116.00	2500	
48x24	MJT4824	MJT4824U	\$14,517.00	2870	
48x30	MJT4830	MJT4830U	\$25,790.00	3050	
48x36	MJT4836	MJT4836U	\$20,480.00	3900	
48x42	MJT4842	MJT4842U	\$25,963.00	4100	
48x48	MJT4848	MJT4848U	\$21,866.00	4250	



\*Weights exclude accessories





IMP-UPL.19.01

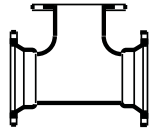

Size (inches)	Item Code Cement Lined w/ Black Coating	Item Code Bare In / Bare Out	Less Accessory List Price	Weight* (lbs.)	Crate Quantity
<b>MJ X FE TEE</b>					
3x3	MJFT0303	MJFT0303U	\$160.00	30	40
4x3	MJFT0403	MJFT0403U	\$180.00	34	16
4x4	MJFT0404	MJFT0404U	\$170.00	40	36
6x3	MJFT0603	MJFT0603U	\$258.00	50	12
6x4	MJFT0604	MJFT0604U	\$269.00	55	24
6x6	MJFT0606	MJFT0606U	\$269.00	56	24
8x3	MJFT0803	MJFT0803U	\$490.00		
8x4	MJFT0804	MJFT0804U	\$314.00	75	18
8x6	MJFT0806	MJFT0806U	\$325.00	80	18
8x8	MJFT0808	MJFT0808U	\$415.00	85	12
10x4	MJFT1004	MJFT1004U	\$445.00	90	6
10x6	MJFT1006	MJFT1006U	\$554.00	100	8
10x8	MJFT1008	MJFT1008U	\$597.00	105	6
10x10	MJFT1010	MJFT1010U	\$760.00	125	4
12x4	MJFT1204	MJFT1204U	\$590.00	118	8
12x6	MJFT1206	MJFT1206U	\$623.00	120	8
12x8	MJFT1208	MJFT1208U	\$692.00	130	8
12x10	MJFT1210	MJFT1210U	\$790.00	150	4
12x12	MJFT1212	MJFT1212U	\$992.00	170	4
14x6	MJFT1406	MJFT1406U	\$1,010.00	205	4
14x8	MJFT1408	MJFT1408U	POA	225	
14x10	MJFT1410	MJFT1410U	\$1,448.00	244	4
14x12	MJFT1412	MJFT1412U	\$1,573.00	284	4
14x14	MJFT1414	MJFT1414U	\$1,688.00	305	
16x6	MJFT1606	MJFT1606U	\$1,139.00	213	2
16x8	MJFT1608	MJFT1608U	\$1,382.00	260	2
16x10	MJFT1610	MJFT1610U	\$1,647.00	287	
16x12	MJFT1612	MJFT1612U	\$1,698.00	312	2
16x14	MJFT1614	MJFT1614U	POA	348	
16x16	MJFT1616	MJFT1616U	\$2,346.00	374	2
18x6	MJFT1806	MJFT1806U	\$1,392.00	261	
18x8	MJFT1808	MJFT1808U	\$1,814.00	351	
18x12	MJFT1812	MJFT1812U	POA	358	
18x16	MJFT1816	MJFT1816U	POA	557	2
18x18	MJFT1818	MJFT1818U	\$6,170.00	445	
20x6	MJFT2006	MJFT2006U	\$1,939.00	345	
20x8	MJFT2008	MJFT2008U	\$4,684.00	339	
20x10	MJFT2010	MJFT2010U	POA	369	
24x6	MJFT2406	MJFT2406U	\$2,217.00	460	
24x8	MJFT2408	MJFT2408U	\$2,578.00	472	
24x10	MJFT2410	MJFT2410U	\$4,868.00	589	2
24x12	MJFT2412	MJFT2412U	\$3,124.00	580	
24x16	MJFT2416	MJFT2416U	\$3,929.00	744	
24x24	MJFT2424	MJFT2424U	\$5,037.00	923	
30x6	MJFT3006	MJFT3006U	\$4,707.00	805	
30x8	MJFT3008	MJFT3008U	POA	695	
30x12	MJFT3012	MJFT3012U	\$6,298.00	715	
30x16	MJFT3016	MJFT3016U	POA	1187	
36x6	MJFT3606	MJFT3606U	\$8,244.00	1175	
36x12	MJFT3612	MJFT3612U	\$8,490.00		
36x16	MJFT3616	MJFT3616U	POA	1475	
36x24	MJFT3624	MJFT3624U	\$16,163.00		
42x12	MJFT4212	MJFT4212U	\$18,228.00		
42x30	MJFT4230	MJFT4230U	\$19,816.00		

\*Weights exclude accessories





IMP-UPL.19.01

Size (inches)	Item Code Cement Lined w/ Black Coating	Item Code Bare In / Bare Out	Less Accessory List Price	Weight* (lbs.)	Crate Quantity
---------------	---	------------------------------------	---------------------------------	-------------------	-------------------

**MJ X PE X MJ TEE**

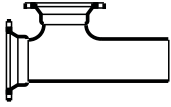

6	MJPT0606	MJPT0606U	\$268.00	57	
8x6	MJPT0806	MJPT0806U	\$355.00	69	
8	MJPT0808	MJPT0808U	\$407.00	78	9
10	MJPT1010	MJPT1010U	\$619.00	120	
12	MJPT1212	MJPT1212U	\$929.00		

**MJ X SWIVEL HYDRANT TEE (W/SWIVEL GLAND)**

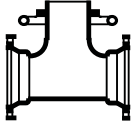

6x6	MJTH0606	MJTH0606U	\$269.00	65	24
8x6	MJTH0806	MJTH0806U	\$337.00	85	16
8x8	MJTH0808	MJTH0808U	\$510.00	100	16
10x6	MJTH1006	MJTH1006U	\$427.00	105	8
10x8	MJTH1008	MJTH1008U	\$567.00	118	4
12x6	MJTH1206	MJTH1206U	\$485.00	126	8
12x8	MJTH1208	MJTH1208U	\$726.00	128	4
14x6	MJTH1406	MJTH1406U	\$1,145.00	211	2
16x6	MJTH1606	MJTH1606U	\$864.00	279	2
16x8	MJTH1608	MJTH1608U	\$2,250.00	298	4
18x6	MJTH1806	MJTH1806U	\$1,499.00	278	
20x6	MJTH2006	MJTH2006U	\$1,487.00	358	
24x6	MJTH2406	MJTH2406U	\$2,153.00	460	
30x6	MJTH3006	MJTH3006U	\$7,266.00		
36x6	MJTH3606	MJTH3606U	\$7,823.00		

**MJ TEE TAPPED (2" TAP)**

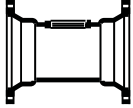

3	MJT0303T	MJT0303TU	\$149.00	18	50
4	MJT0404T	MJT0404TU	\$168.00	25	48
6	MJT0606T	MJT0606TU	\$196.00	35	9
8	MJT0808T	MJT0808TU	\$326.00	55	8
10	MJT1010T	MJT1010TU	\$700.00	70	6
12	MJT1212T	MJT1212TU	\$879.00	85	8
16	MJT1616T	MJT1616TU	\$949.00	164	

The standard tap size is 2" NPT. For other sizes, please contact Star® Pipe Products. Taps other than 2" NPT are special order, non-cancellable & non-refundable.

**MJ PLUG - SOLID**

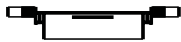

Size (inches)	Item Code	Item Code	Less Accessory List Price	Weight* (lbs.)	Crate Quantity
2	MJP02	MJP02U			(SEE C110 MJ)
3	MJP03	MJP03U	\$54.00	8	100
4	MJP04	MJP04U	\$46.00	10	100
6	MJP06	MJP06U	\$87.00	16	120
8	MJP08	MJP08U	\$129.00	26	99
10	MJP10	MJP10U	\$225.00	36	36
12	MJP12	MJP12U	\$222.00	46	40
14	MJP14	MJP14U	\$458.00	75	16
16	MJP16	MJP16U	\$585.00	95	10
18	MJP18	MJP18U	\$725.00	121	4
20	MJP20	MJP20U	\$953.00	135	4
24	MJP24	MJP24U	\$1,322.00	175	4
30	MJP30	MJP30U	\$2,622.00	355	
36	MJP36	MJP36U	\$4,049.00	688	
42	MJP42	MJP42U	\$5,617.00	1067	
48	MJP48	MJP48U	\$7,487.00	1313	



IMP-UPL.19.01

Size (inches)	Item Code Cement Lined w/ Black Coating	Item Code Bare In / Bare Out	Less Accessory List Price	Weight* (lbs.)	Crate Quantity
---------------	---	------------------------------------	---------------------------------	-------------------	-------------------

**MJ PLUG - TAPPED (2" TAP)**

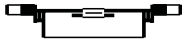

Size (inches)	Item Code Cement Lined w/ Black Coating	Item Code Bare In / Bare Out	Less Accessory List Price	Weight* (lbs.)	Crate Quantity
2	MJP02T	MJP02TU		(SEE C110 MJ)	
3	MJP03T	MJP03TU	\$92.00	8	100
4	MJP04T	MJP04TU	\$85.00	10	100
6	MJP06T	MJP06TU	\$125.00	20	120
8	MJP08T	MJP08TU	\$168.00	30	99
10	MJP10T	MJP10TU	\$264.00	40	36
12	MJP12T	MJP12TU	\$259.00	50	24
14	MJP14T	MJP14TU	\$520.00	77	16
16	MJP16T	MJP16TU	\$647.00	101	10
18	MJP18T	MJP18TU	\$804.00	130	4
20	MJP20T	MJP20TU	\$1,032.00	153	4
24	MJP24T	MJP24TU	\$1,399.00	202	4
30	MJP30T	MJP30TU	\$2,738.00	433	
36	MJP36T	MJP36TU	\$4,167.00	674	
42	MJP42T	MJP42TU	\$5,773.00	1067	
48	MJP48T	MJP48TU	\$7,643.00	1313	

The standard tap size is 2" NPT. For other sizes, please contact Star® Pipe Products. Taps other than 2" NPT are special order, non-cancellable & non-refundable.

**MJ SOLID SLEEVE SHORT**

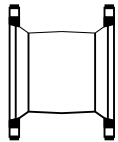

Size (inches)	Item Code Cement Lined w/ Black Coating	Item Code Bare In / Bare Out	Less Accessory List Price	Weight* (lbs.)	Crate Quantity
3	MJSS03	MJSS03U	\$66.00	12	48
4	MJSS04	MJSS04U	\$62.00	15	100
6	MJSS06	MJSS06U	\$110.00	23	48
8	MJSS08	MJSS08U	\$143.00	31	36
10	MJSS10	MJSS10U	\$258.00	45	12
12	MJSS12	MJSS12U	\$290.00	57	20
14	MJSS14	MJSS14U	\$545.00	94	6
16	MJSS16	MJSS16U	\$677.00	118	6
18	MJSS18	MJSS18U	\$856.00	145	2
20	MJSS20	MJSS20U	\$1,047.00	173	2
24	MJSS24	MJSS24U	\$1,386.00	226	2
30	MJSS30	MJSS30U	\$2,850.00	472	2
36	MJSS36	MJSS36U	\$3,868.00	673	
42	MJSS42	MJSS42U	\$5,502.00	877	
48	MJSS48	MJSS48U	\$6,876.00	1136	2

**MJ SOLID SLEEVE LONG**

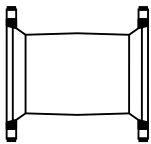

Size (inches)	Item Code Cement Lined w/ Black Coating	Item Code Bare In / Bare Out	Less Accessory List Price	Weight* (lbs.)	Crate Quantity
2	MJSL02	MJSL02U	\$102.00	7	50
3	MJSL03	MJSL03U	\$77.00	17	50
4	MJSL04	MJSL04U	\$88.00	22	75
6	MJSL06	MJSL06U	\$147.00	29	48
8	MJSL08	MJSL08U	\$238.00	45	27
10	MJSL10	MJSL10U	\$284.00	61	27
12	MJSL12	MJSL12U	\$383.00	79	18
14	MJSL14	MJSL14U	\$578.00	128	8
16	MJSL16	MJSL16U	\$732.00	159	8
18	MJSL18	MJSL18U	\$936.00	200	2
20	MJSL20	MJSL20U	\$1,129.00	236	2
24	MJSL24	MJSL24U	\$1,487.00	306	2
30	MJSL30	MJSL30U	\$3,114.00	634	



\*Weights exclude accessories



IMP-UPL.19.01

Size (inches)	Item Code Cement Lined w/ Black Coating	Item Code Bare In / Bare Out	Less Accessory List Price	Weight* (lbs.)	Crate Quantity
36	MJSL36	MJSL36U	\$4,372.00	889	
42	MJSL42	MJSL42U	\$5,846.00	1165	
48	MJSL48	MJSL48U	\$8,212.00	1482	

MJ DUAL PURPOSE SLEEVE

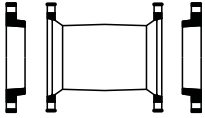

Size (inches)	Item Code	Item Code	Less Accessory List Price	Weight* (lbs.)	Crate Quantity
4	MJSDP04	MJSDP04U	POA	38	25
6	MJSDP06	MJSDP06U	POA	60	48
8	MJSDP08	MJSDP08U	POA	76	27
10	MJSDP10	MJSDP10U	POA	104	9
12	MJSDP12	MJSDP12U	POA	127	8
16	MJSDP16	MJSDP16U	POA	270	2

MJ CAP - SOLID

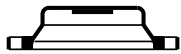

Size (inches)	Item Code	Item Code	Less Accessory List Price	Weight* (lbs.)	Crate Quantity
2	MJC02	MJC02U			(SEE C110 MJ)
3	MJC03	MJC03U	\$36.00	8	100
4	MJC04	MJC04U	\$37.00	9	300
6	MJC06	MJC06U	\$66.00	15	132
8	MJC08	MJC08U	\$108.00	22	99
10	MJC10	MJC10U	\$135.00	32	54
12	MJC12	MJC12U	\$202.00	42	52
14	MJC14	MJC14U	\$305.00	66	16
16	MJC16	MJC16U	\$408.00	92	16
18	MJC18	MJC18U	\$498.00	114	8
20	MJC20	MJC20U	\$645.00	125	6
24	MJC24	MJC24U	\$885.00	166	6
30	MJC30	MJC30U	\$2,019.00	345	
36	MJC36	MJC36U	\$3,674.00	628	
42	MJC42	MJC42U	\$5,569.00	893	
48	MJC48	MJC48U	\$6,712.00	1076	

MJ CAP - TAPPED (2" TAP)

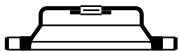

Size (inches)	Item Code	Item Code	Less Accessory List Price	Weight* (lbs.)	Crate Quantity
2	MJC02T	MJC02TU			(SEE C110 MJ)
3	MJC03T	MJC03TU	\$76.00	8	100
4	MJC04T	MJC04TU	\$77.00	12	300
6	MJC06T	MJC06TU	\$106.00	15	132
8	MJC08T	MJC08TU	\$147.00	25	99
10	MJC10T	MJC10TU	\$174.00	35	54
12	MJC12T	MJC12TU	\$242.00	45	52
14	MJC14T	MJC14TU	\$367.00	72	16
16	MJC16T	MJC16TU	\$469.00	98	20
18	MJC18T	MJC18TU	\$577.00	122	8
20	MJC20T	MJC20TU	\$723.00	148	8
24	MJC24T	MJC24TU	\$963.00	202	8
30	MJC30T	MJC30TU	\$2,136.00	385	
36	MJC36T	MJC36TU	\$3,789.00	614	
42	MJC42T	MJC42TU	\$5,725.00	893	
48	MJC48T	MJC48TU	\$6,867.00	1076	

The standard tap size is 2" NPT. For other sizes, please contact Star® Pipe Products. Taps other than 2" NPT are special order, non-cancellable & non-refundable.



IMP-UPL.19.01

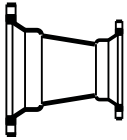

Size (inches)	Item Code Cement Lined w/ Black Coating	Item Code Bare In / Bare Out	Less Accessory List Price	Weight* (lbs.)	Crate Quantity
<b>MJ REDUCER</b>					
3x2	MJR0302	MJR0302U		(SEE C110 MJ)	
4x2	MJR0402	MJR0402U		(SEE C110 MJ)	
4x3	MJR0403	MJR0403U	\$85.00	18	80
6x2	MJR0602	MJR0602U	\$155.00		
6x3	MJR0603	MJR0603U	\$112.00	22	32
6x4	MJR0604	MJR0604U	\$94.00	24	64
8x3	MJR0803	MJR0803U	\$168.00	30	48
8x4	MJR0804	MJR0804U	\$129.00	32	36
8x6	MJR0806	MJR0806U	\$137.00	36	36
10x4	MJR1004	MJR1004U	\$209.00	46	9
10x6	MJR1006	MJR1006U	\$176.00	47	27
10x8	MJR1008	MJR1008U	\$194.00	50	18
12x4	MJR1204	MJR1204U	\$266.00	58	4
12x6	MJR1206	MJR1206U	\$233.00	58	8
12x8	MJR1208	MJR1208U	\$238.00	57	12
12x10	MJR1210	MJR1210U	\$264.00	61	12
14x6	MJR1406	MJR1406U	\$552.00	100	4
14x8	MJR1408	MJR1408U	\$552.00	100	4
14x10	MJR1410	MJR1410U	\$415.00	100	4
14x12	MJR1412	MJR1412U	\$415.00	100	4
16x6	MJR1606	MJR1606U	\$604.00	124	4
16x8	MJR1608	MJR1608U	\$580.00	124	4
16x10	MJR1610	MJR1610U	\$559.00	124	4
16x12	MJR1612	MJR1612U	\$539.00	112	4
16x14	MJR1614	MJR1614U	\$684.00	140	4
18x4	MJR1804	MJR1804U	\$1,334.00	152	4
18x8	MJR1808	MJR1808U	\$874.00	190	2
18x10	MJR1810	MJR1810U	\$826.00	195	2
18x12	MJR1812	MJR1812U	\$804.00	180	
18x14	MJR1814	MJR1814U	\$1,093.00	190	
18x16	MJR1816	MJR1816U	\$853.00	195	
20x6	MJR2006	MJR2006U	\$2,010.00	232	4
20x8	MJR2008	MJR2008U	\$1,018.00	227	
20x10	MJR2010	MJR2010U	\$1,159.00	220	
20x12	MJR2012	MJR2012U	\$894.00	205	
20x14	MJR2014	MJR2014U	\$890.00	200	
20x16	MJR2016	MJR2016U	\$826.00	200	
20x18	MJR2018	MJR2018U	\$1,112.00	225	
24x8	MJR2408	MJR2408U	\$2,385.00	263	
24x10	MJR2410	MJR2410U	\$2,784.00	305	2
24x12	MJR2412	MJR2412U	\$1,368.00	305	
24x14	MJR2414	MJR2414U	\$3,062.00	310	
24x16	MJR2416	MJR2416U	\$1,420.00	320	
24x18	MJR2418	MJR2418U	\$1,358.00	305	
24x20	MJR2420	MJR2420U	\$1,683.00	300	
30x12	MJR3012	MJR3012U	\$4,988.00	705	
30x16	MJR3016	MJR3016U	\$3,084.00	633	
30x18	MJR3018	MJR3018U	\$3,199.00	658	
30x20	MJR3020	MJR3020U	\$3,027.00	628	
30x24	MJR3024	MJR3024U	\$2,312.00	478	
36x12	MJR3612	MJR3612U	\$6,373.00	1037	
36x16	MJR3616	MJR3616U	\$3,816.00	1078	



\*Weights exclude accessories



IMP-UPL.19.01

Size (inches)	Item Code Cement Lined w/ Black Coating	Item Code Bare In / Bare Out	Less Accessory List Price	Weight* (lbs.)	Crate Quantity
36x18	MJR3618	MJR3618U	\$7,772.00	1329	
36x20	MJR3620	MJR3620U	\$4,689.00	975	
36x24	MJR3624	MJR3624U	\$3,723.00	770	
36x30	MJR3630	MJR3630U	\$4,049.00	650	
42x16	MJR4216	MJR4216U	POA		
42x18	MJR4218	MJR4218U	POA		
42x20	MJR4220	MJR4220U	\$6,126.00		
42x24	MJR4224	MJR4224U	\$6,977.00	1356	
42x30	MJR4230	MJR4230U	\$5,492.00	1083	
42x36	MJR4236	MJR4236U	\$5,740.00	1114	
48x16	MJR4816	MJR4816U	POA		
48x18	MJR4818	MJR4818U	POA		
48x20	MJR4820	MJR4820U	\$7,714.00		
48x24	MJR4824	MJR4824U	\$7,906.00	1700	
48x30	MJR4830	MJR4830U	\$9,528.00	1779	
48x36	MJR4836	MJR4836U	\$8,395.00	1641	
48x42	MJR4842	MJR4842U	\$9,267.00	1426	

**MJ SMALL END BELL (SEB) REDUCER**

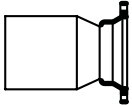

Size	Item Code	Item Code	(SEE C110 MJ)	Weight	Quantity
3x2	MJRS0302	MJRS0302U			
4x2	MJRS0402	MJRS0402U	\$193.00	29	36
4x3	MJRS0403	MJRS0403U	\$78.00	17	32
6x3	MJRS0603	MJRS0603U	\$134.00	24	16
6x4	MJRS0604	MJRS0604U	\$97.00	25	50
8x4	MJRS0804	MJRS0804U	\$163.00	30	9
8x6	MJRS0806	MJRS0806U	\$148.00	35	24
10x4	MJRS1004	MJRS1004U	\$218.00	43	4
10x6	MJRS1006	MJRS1006U	\$228.00	46	4
10x8	MJRS1008	MJRS1008U	\$244.00	42	12
12x4	MJRS1204	MJRS1204U	\$312.00	60	4
12x6	MJRS1206	MJRS1206U	\$326.00	58	6
12x8	MJRS1208	MJRS1208U	\$255.00	54	6
12x10	MJRS1210	MJRS1210U	\$308.00	59	6
14x6	MJRS1406	MJRS1406U	\$719.00	100	
14x8	MJRS1408	MJRS1408U	\$913.00	98	
14x10	MJRS1410	MJRS1410U	POA	94	4
14x12	MJRS1412	MJRS1412U	\$908.00	90	4
16x6	MJRS1606	MJRS1606U	\$685.00	125	4
16x8	MJRS1608	MJRS1608U	\$670.00	121	4
16x10	MJRS1610	MJRS1610U	\$679.00	105	4
16x12	MJRS1612	MJRS1612U	\$620.00	109	4
16x14	MJRS1614	MJRS1614U	POA	126	4
18x8	MJRS1808	MJRS1808U	\$1,233.00	170	
18x10	MJRS1810	MJRS1810U	POA	165	
18x12	MJRS1812	MJRS1812U	\$819.00	150	
18x14	MJRS1814	MJRS1814U	POA	175	
18x16	MJRS1816	MJRS1816U	\$1,413.00	170	
20x8	MJRS2008	MJRS2008U	\$1,912.00		
20x10	MJRS2010	MJRS2010U	\$1,240.00	200	
20x12	MJRS2012	MJRS2012U	\$929.00	170	
20x14	MJRS2014	MJRS2014U	\$1,068.00	190	
20x16	MJRS2016	MJRS2016U	\$1,012.00	185	
20x18	MJRS2018	MJRS2018U	POA	200	
24x8	MJRS2408	MJRS2408U	\$2,209.00		

\*Weights exclude accessories





IMP-UPL.19.01

Size (inches)	Item Code Cement Lined w/ Black Coating	Item Code Bare In / Bare Out	Less Accessory List Price	Weight* (lbs.)	Crate Quantity
24x12	MJRS2412	MJRS2412U	\$1,503.00	275	
24x14	MJRS2414	MJRS2414U	POA	310	
24x16	MJRS2416	MJRS2416U	\$1,558.00	285	
24x18	MJRS2418	MJRS2418U	\$1,759.00	300	
24x20	MJRS2420	MJRS2420U	\$1,683.00	270	
30x16	MJRS3016	MJRS3016U	\$3,353.00	565	
30x18	MJRS3018	MJRS3018U	POA	590	
30x20	MJRS3020	MJRS3020U	\$3,452.00	560	
30x24	MJRS3024	MJRS3024U	\$4,143.00	495	
36x16	MJRS3616	MJRS3616U	\$5,806.00	620	
36x20	MJRS3620	MJRS3620U	\$5,028.00	874	
36x24	MJRS3624	MJRS3624U	\$4,363.00	746	
36x30	MJRS3630	MJRS3630U	\$4,888.00	725	
42x24	MJRS4224	MJRS4224U	\$7,508.00	1204	
42x30	MJRS4230	MJRS4230U	\$5,806.00	931	
42x36	MJRS4236	MJRS4236U	\$6,380.00	962	
48x30	MJRS4830	MJRS4830U	\$12,048.00		
48x42	MJRS4842	MJRS4842U	\$12,828.00		

MJ LARGE END BELL (LEB) REDUCER

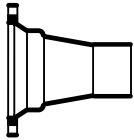

4x3	MJRL0403	MJRL0403U	\$90.00	18	40
6x3	MJRL0603	MJRL0603U	\$129.00	19	30
6x4	MJRL0604	MJRL0604U	\$148.00	25	30
8x4	MJRL0804	MJRL0804U	\$168.00	34	27
8x6	MJRL0806	MJRL0806U	\$135.00	32	27
10x4	MJRL1004	MJRL1004U	\$220.00	43	
10x6	MJRL1006	MJRL1006U	\$228.00	42	4
10x8	MJRL1008	MJRL1008U	\$248.00	50	4
12x4	MJRL1204	MJRL1204U	\$376.00	60	4
12x6	MJRL1206	MJRL1206U	\$303.00	58	4
12x8	MJRL1208	MJRL1208U	\$312.00	55	4
12x10	MJRL1210	MJRL1210U	\$322.00	59	4
14x6	MJRL1406	MJRL1406U	\$552.00	104	
14x8	MJRL1408	MJRL1408U	\$552.00	98	
14x10	MJRL1410	MJRL1410U	\$415.00	92	8
14x12	MJRL1412	MJRL1412U	\$504.00	92	
16x6	MJRL1606	MJRL1606U	\$745.00	136	4
16x8	MJRL1608	MJRL1608U	\$790.00	128	4
16x10	MJRL1610	MJRL1610U	\$685.00	123	4
16x12	MJRL1612	MJRL1612U	\$542.00	108	4
16x14	MJRL1614	MJRL1614U	\$723.00	132	4
18x8	MJRL1808	MJRL1808U	\$874.00	195	
18x10	MJRL1810	MJRL1810U	POA	185	
18x12	MJRL1812	MJRL1812U	\$957.00	175	
18x14	MJRL1814	MJRL1814U	\$1,093.00	190	
18x16	MJRL1816	MJRL1816U	\$1,050.00	190	
20x10	MJRL2010	MJRL2010U	\$1,148.00	210	
20x12	MJRL2012	MJRL2012U	\$1,584.00	205	
20x14	MJRL2014	MJRL2014U	\$890.00	205	
20x16	MJRL2016	MJRL2016U	\$826.00	200	
20x18	MJRL2018	MJRL2018U	POA	215	
24x12	MJRL2412	MJRL2412U	\$1,584.00	290	
24x14	MJRL2414	MJRL2414U	\$3,062.00	315	
24x16	MJRL2416	MJRL2416U	\$1,609.00	285	

\*Weights exclude accessories





IMP-UPL.19.01

Size (inches)	Item Code Cement Lined w/ Black Coating	Item Code Bare In / Bare Out	Less Accessory List Price	Weight* (lbs.)	Crate Quantity
24x18	MJRL2418	MJRL2418U	\$1,358.00		
24x20	MJRL2420	MJRL2420U	\$3,267.00	275	2
30x18	MJRL3018	MJRL3018U	\$3,199.00		
30x24	MJRL3024	MJRL3024U	\$4,218.00	526	1
36x24	MJRL3624	MJRL3624U	\$5,863.00	810	1
36x30	MJRL3630	MJRL3630U	\$4,049.00		
42x30	MJRL4230	MJRL4230U	\$5,492.00		
42x36	MJRL4236	MJRL4236U	POA	1013	
48x30	MJRL4830	MJRL4830U	\$11,829.00		
48x36	MJRL4836	MJRL4836U	\$12,675.00		

PE X PE REDUCER



4x3	MJRP0403	MJRP0403U	\$75.00	14	30
6x3	MJRP0603	MJRP0603U	\$118.00	19	
6x4	MJRP0604	MJRP0604U	\$114.00	22	25
8x4	MJRP0804	MJRP0804U	\$170.00	30	16
8x6	MJRP0806	MJRP0806U	\$179.00	30	16
10x4	MJRP1004	MJRP1004U	\$379.00		
10x6	MJRP1006	MJRP1006U	\$235.00	46	9
10x8	MJRP1008	MJRP1008U	\$242.00	47	9
12x4	MJRP1204	MJRP1204U	\$297.00	58	9
12x6	MJRP1206	MJRP1206U	\$297.00	57	9
12x8	MJRP1208	MJRP1208U	\$306.00	54	9
12x10	MJRP1210	MJRP1210U	\$277.00	54	9
14x12	MJRP1412	MJRP1412U	\$455.00	88	
16x6	MJRP1606	MJRP1606U	\$510.00	93	
16x8	MJRP1608	MJRP1608U	\$663.00	119	
16x10	MJRP1610	MJRP1610U	\$652.00	119	
16x12	MJRP1612	MJRP1612U	\$543.00	99	
16x14	MJRP1614	MJRP1614U	\$863.00	129	
18x10	MJRP1810	MJRP1810U	\$1,944.00	160	
18x12	MJRP1812	MJRP1812U	\$728.00	150	
20x12	MJRP2012	MJRP2012U	\$1,807.00	190	2
20x16	MJRP2016	MJRP2016U	\$1,838.00	170	2
24x8	MJRP2408	MJRP2408U	\$1,649.00	173	2
24x20	MJRP2420	MJRP2420U	\$1,802.00	240	2
30x16	MJRP3016	MJRP3016U	\$7,500.00	555	

MJ X MJ ECCENTRIC REDUCER

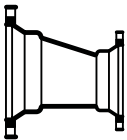

20x18	MJER2018	MJER2018U	POA	235	
36x30	MJER3630	MJER3630U	POA	650	
42x36	MJER4236	MJER4236U	POA	1114	
48x30	MJER4830	MJER4830U	POA	1779	

MJ X FE REDUCER

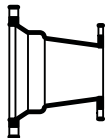

4x3	MJFR0403	MJFR0403U	POA	17	32
6x4	MJFR0604	MJFR0604U	POA	23	32
8x6	MJFR0806	MJFR0806U	POA	34	18
10x8	MJFR1008	MJFR1008U	POA	63	24
12x6	MJFR1206	MJFR1206U	POA	71	24
12x8	MJFR1208	MJFR1208U	POA	58	12
18x8	MJFR1808	MJFR1808U	POA	190	2
18x12	MJFR1812	MJFR1812U	POA	198	
24x12	MJFR2412	MJFR2412U	POA	318	2





IMP-UPL.19.01

Size (inches)	Item Code Cement Lined w/ Black Coating	Item Code Bare In / Bare Out	Less Accessory List Price	Weight* (lbs.)	Crate Quantity
<b>MJ CROSS</b>					
3x3	MJX0303	MJX0303U	\$164.00	35	12
4x3	MJX0403	MJX0403U	\$195.00	49	12
4x4	MJX0404	MJX0404U	\$278.00	40	12
6x4	MJX0604	MJX0604U	\$304.00	70	6
6x6	MJX0606	MJX0606U	\$340.00	75	12
8x4	MJX0804	MJX0804U	\$480.00	97	6
8x6	MJX0806	MJX0806U	\$353.00	103	12
8x8	MJX0808	MJX0808U	\$372.00	105	12
10x4	MJX1004	MJX1004U	\$469.00	120	4
10x6	MJX1006	MJX1006U	\$455.00	125	4
10x8	MJX1008	MJX1008U	\$564.00	130	8
10x10	MJX1010	MJX1010U	\$595.00	145	8
12x4	MJX1204	MJX1204U	\$583.00	123	4
12x6	MJX1206	MJX1206U	\$574.00	159	8
12x8	MJX1208	MJX1208U	\$660.00	165	8
12x10	MJX1210	MJX1210U	\$1,043.00	187	4
12x12	MJX1212	MJX1212U	\$1,043.00	213	4
14x6	MJX1406	MJX1406U	\$1,039.00	210	2
14x8	MJX1408	MJX1408U	\$1,175.00	231	
14x10	MJX1410	MJX1410U	POA	255	
14x12	MJX1412	MJX1412U	\$2,113.00	269	
14x14	MJX1414	MJX1414U	\$1,830.00	299	4
16x6	MJX1606	MJX1606U	\$1,249.00	250	2
16x8	MJX1608	MJX1608U	\$1,444.00	264	2
16x10	MJX1610	MJX1610U	\$1,885.00	286	
16x12	MJX1612	MJX1612U	\$1,984.00	310	2
16x14	MJX1614	MJX1614U	POA	395	2
16x16	MJX1616	MJX1616U	\$2,886.00	385	2
18x6	MJX1806	MJX1806U	\$3,538.00	386	2
18x10	MJX1810	MJX1810U	\$4,250.00		
18x12	MJX1812	MJX1812U	\$3,502.00	437	
18x18	MJX1818	MJX1818U	\$3,586.00	657	
20x6	MJX2006	MJX2006U	\$3,153.00	285	2
20x8	MJX2008	MJX2008U	\$2,402.00	440	
20x10	MJX2010	MJX2010U	\$2,952.00		
20x12	MJX2012	MJX2012U	\$2,256.00	558	
20x16	MJX2016	MJX2016U	\$3,710.00		
20x18	MJX2018	MJX2018U	\$3,810.00	698	
20x20	MJX2020	MJX2020U	\$5,179.00	798	
24x6	MJX2406	MJX2406U	\$2,627.00	481	
24x8	MJX2408	MJX2408U	\$2,729.00	500	
24x10	MJX2410	MJX2410U	\$5,299.00		
24x12	MJX2412	MJX2412U	\$3,385.00	620	
24x16	MJX2416	MJX2416U	\$3,929.00	720	
24x18	MJX2418	MJX2418U	\$4,737.00	868	
24x20	MJX2420	MJX2420U	\$5,534.00	1014	
24x24	MJX2424	MJX2424U	\$4,902.00	1038	
30x6	MJX3006	MJX3006U	\$7,516.00		
30x8	MJX3008	MJX3008U	\$7,287.00		
30x12	MJX3012	MJX3012U	\$6,615.00	1130	
30x16	MJX3016	MJX3016U	\$11,226.00	866	1
30x24	MJX3024	MJX3024U	\$11,226.00	1640	

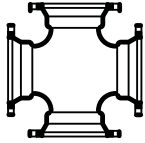



IMP-UPL.19.01

Size (inches)	Item Code Cement Lined w/ Black Coating	Item Code Bare In / Bare Out	Less Accessory List Price	Weight* (lbs.)	Crate Quantity
30x30	MJX3030	MJX3030U	\$10,756.00	1840	
36x24	MJX3624	MJX3624U	\$14,747.00	1955	
36x36	MJX3636	MJX3636U	\$15,522.00	2655	
42x12	MJX4212	MJX4212U	\$13,222.00		
42x16	MJX4216	MJX4216U	\$14,057.00		
42x24	MJX4224	MJX4224U	\$15,379.00		
42x30	MJX4230	MJX4230U	\$26,877.00		
42x36	MJX4236	MJX4236U	\$30,783.00	3375	
42x42	MJX4242	MJX4242U	\$34,837.00		
48x12	MJX4812	MJX4812U	\$19,659.00		
48x16	MJX4816	MJX4816U	\$20,873.00		
48x24	MJX4824	MJX4824U	\$31,425.00	3670	
48x30	MJX4830	MJX4830U	\$32,579.00	4506	
48x36	MJX4836	MJX4836U	\$32,530.00	4700	
48X42	MJX4842	MJX4842U	\$32,530.00		
48X48	MJX4848	MJX4848U	\$30,894.00		

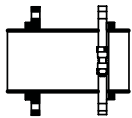

**MJ SWIVEL X SOLID HYDRANT ADAPTER (W/ SWIVEL GLAND)**

4x13	MJHA0413	MJHA0413U	\$150.00	29	18
6x13	MJHA0613	MJHA0613U	\$266.00	47	36
6x18	MJHA0618	MJHA0618U	\$293.00	56	12
6x24	MJHA0624	MJHA0624U	\$396.00	60	16
6x36	MJHA0636	MJHA0636U	\$502.00	75	6
6x48	MJHA0648	MJHA0648U	\$659.00	94	12
8x13	MJHA0813	MJHA0813U	\$340.00	54	18
8x18	MJHA0818	MJHA0818U	POA	67	
8x24	MJHA0824	MJHA0824U	POA	82	
8x48	MJHA0848	MJHA0848U	POA	143	
10x13	MJHA1013	MJHA1013U	\$605.00	86	12
12x13	MJHA1213	MJHA1213U	\$897.00	120	8

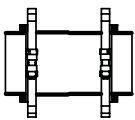

**SWIVEL x SWIVEL HYDRANT ADAPTER (WITH 2 SWIVEL GLANDS)**

6x12	HHA0612	HHA0612U	POA	28	
6x13	HHA0613	HHA0613U	\$235.00	28	48
6x18	HHA0618	HHA0618U	POA	49	
6x24	HHA0624	HHA0624U	\$318.00	52	
8X13	HHA0813	HHA0813U	\$340.00		

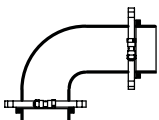

**SWIVEL X SWIVEL HYDRANT ELL (W/ 2 SWIVEL GLANDS)**

6	MJHB9006	MJHB9006U	\$310.00	50	18
---	----------	-----------	----------	----	----

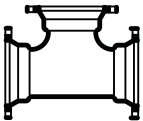

**MJ REDUCING ON RUN TEES**

6x4x6	MJT060406	MJT060406U	\$524.00	60	12
6x6x8	MJT060608	MJT060608U	\$459.00	75	18
8x6x6	MJT080606	MJT080606U	\$732.00	75	9
8x6x8	MJT080608	MJT080608U	\$732.00	85	9

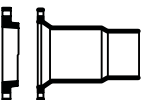

**MJ X PE CUTTING IN SLEEVE WITH OVERSIZED GLAND\***

4	MJSC04	MJSC04U	POA	50	6
6	MJSC06	MJSC06U	POA	62	6
8	MJSC08	MJSC08U	POA	90	6
10	MJSC10	MJSC10U	POA	105	4



IMP-UPL.19.01

Size (inches)	Item Code Cement Lined w/ Black Coating	Item Code Bare In / Bare Out	Less Accessory List Price	Weight* (lbs.)	Crate Quantity
12	MJSC12	MJSC12U	POA	128	4
16	MJSC16	MJSC16U	POA	275	

**HYDRANT BURY EXTENSION**

6	HBEX06	HBEX06U	POA	50	60
12	HBEX12	HBEX12U	POA	73	36

**MJ TANGENTIAL TEE**

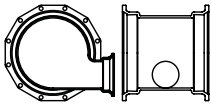

16x6	MJTT1606	MJTT1606U	POA	270	
16x12	MJTT1612	MJTT1612U	POA	344	
18x6	MJTT1806	MJTT1806U	POA	306	
24x6	MJTT2406	MJTT2406U	POA	375	
24x12	MJTT2412	MJTT2412U	POA	450	

**MJ X MJ OFFSET**

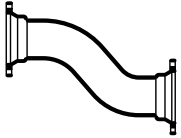

3x6	MJO0306	MJO0306U	\$116.00	20	
3x12	MJO0312	MJO0312U	\$169.00	40	
3x18	MJO0318	MJO0318U	\$196.00	49	
3x24	MJO0324	MJO0324U	\$234.00	55	
4x6	MJO0406	MJO0406U	\$158.00	25	12
4x12	MJO0412	MJO0412U	\$204.00	55	12
4x18	MJO0418	MJO0418U	\$275.00	65	8
4x24	MJO0424	MJO0424U	\$317.00	75	16
6x6	MJO0606	MJO0606U	\$269.00	29	12
6x12	MJO0612	MJO0612U	\$350.00	69	16
6x18	MJO0618	MJO0618U	\$428.00	87	8
6x24	MJO0624	MJO0624U	\$542.00	107	8
8x6	MJO0806	MJO0806U	\$387.00	80	4
8x12	MJO0812	MJO0812U	\$498.00	104	4
8x18	MJO0818	MJO0818U	\$622.00	135	4
8x24	MJO0824	MJO0824U	\$884.00	141	3
10x6	MJO1006	MJO1006U	\$554.00	110	4
10x12	MJO1012	MJO1012U	\$728.00	135	4
10x18	MJO1018	MJO1018U	\$868.00	165	4
10x24	MJO1024	MJO1024U	\$1,699.00	175	4
12x6	MJO1206	MJO1206U	\$784.00	118	4
12x12	MJO1212	MJO1212U	\$870.00	203	4
12x18	MJO1218	MJO1218U	\$1,053.00	230	4
12x24	MJO1224	MJO1224U	\$1,487.00	277	2
12x30	MJO1230	MJO1230U	\$1,414.00		
16x12	MJO1612	MJO1612U	\$4,780.00	305	
16x18	MJO1618	MJO1618U	\$5,652.00	362	
20x12	MJO2012	MJO2012U	\$6,828.00	437	
20x18	MJO2018	MJO2018U	\$9,078.00	581	

**MJ X PE OFFSET**



3x6	MJOP0306	MJOP0306U	\$150.00		
3x12	MJOP0312	MJOP0312U	\$200.00		
3x18	MJOP0318	MJOP0318U	\$245.00		
3x24	MJOP0324	MJOP0324U	\$273.00		
4x6	MJOP0406	MJOP0406U	\$225.00	25	12
4x12	MJOP0412	MJOP0412U	\$277.00	46	12



# C153 Ductile Iron Compact Mechanical Joint Fittings

Price List  
**MJ COMPACT**

IMP-UPL.19.01

Size (inches)	Item Code Cement Lined w/ Black Coating	Item Code Bare In / Bare Out	Less Accessory List Price	Weight* (lbs.)	Crate Quantity
4x18	MJOP0418	MJOP0418U	\$334.00	59	16
4x24	MJOP0424	MJOP0424U	\$367.00	65	6
6x6	MJOP0606	MJOP0606U	\$264.00	51	12
6x12	MJOP0612	MJOP0612U	\$346.00	68	8
6x18	MJOP0618	MJOP0618U	\$489.00	97	8
6x24	MJOP0624	MJOP0624U	\$596.00	116	4
8x6	MJOP0806	MJOP0806U	\$398.00	84	4
8x12	MJOP0812	MJOP0812U	\$559.00	110	4
8x18	MJOP0818	MJOP0818U	\$630.00	124	4
8x24	MJOP0824	MJOP0824U	\$666.00	147	3
10x6	MJOP1006	MJOP1006U	\$662.00	127	6
10x12	MJOP1012	MJOP1012U	\$874.00	130	4
10x18	MJOP1018	MJOP1018U	\$959.00	160	4
10x24	MJOP1024	MJOP1024U	\$1,206.00	169	4
12x6	MJOP1206	MJOP1206U	\$992.00	115	4
12x12	MJOP1212	MJOP1212U	\$1,006.00	198	4
12x18	MJOP1218	MJOP1218U	\$1,372.00	270	4
12x24	MJOP1224	MJOP1224U	\$1,696.00	195	2
12x30	MJOP1230	MJOP1230U	\$1,043.00		

### MJ X SWIVEL OFFSET (W/ SWIVEL GLAND)

6x6	MJOH0606	MJOH0606U	POA	66	15
6x12	MJOH0612	MJOH0612U	POA	95	10
6x24	MJOH0624	MJOH0624U	POA	132	6



\*Weights exclude accessories