

# DOMESTIC PRICE LIST

## **C153 DI COMPACT MJ FITTINGS**

### **ANSI/AWWA C153/A21.53**

version: **DOM-UPL.15.01**  
EFFECTIVE: JANUARY 12, 2015  
(SUPERSEDES ALL PREVIOUS PRICING)

#### **WEST COAST (U.S.)**

Toll Free: (877) 701-7827  
Fax: (951) 898-9561

#### **CENTRAL (U.S.)**

Toll Free: (800) 999-3009  
Fax: (281) 558-9000

#### **CAMBRIDGE (CANADA)**

Toll Free: (888) 893-7827  
Fax: (519) 650-1553



Star Pipe Products  
4018 Westhollow Parkway  
Houston, Texas 77082  
[www.starpipeproducts.com](http://www.starpipeproducts.com)

Corporate Headquarters  
800.999.3009 Toll Free  
281.558.3000 Telephone  
281.558.9000 Fax



DOM-UPL.15.01

Size (inches)	Item Code Cement Lined w/ Black Coating	Item Code Bare In / Bare Out	Less Accessory List Price	Weight* (lbs.)	Crate Quantity
---------------	---	------------------------------	---------------------------	----------------	----------------

**90° (1/4) MJ BEND**

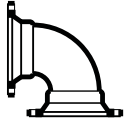

3	MJB9003D	MJB9003UD	\$90.00	19	80
4	MJB9004D	MJB9004UD	\$92.00	25	80
6	MJB9006D	MJB9006UD	\$145.00	39	36
8	MJB9008D	MJB9008UD	\$213.00	57	18
10	MJB9010D	MJB9010UD	\$370.00	89	8
12	MJB9012D	MJB9012UD	\$537.00	108	8
14	MJB9014D	MJB9014UD	\$969.00	210	2
16	MJB9016D	MJB9016UD	\$1,224.00	264	2
18	MJB9018D	MJB9018UD	\$1,674.00	335	
20	MJB9020D	MJB9020UD	\$2,032.00	400	
24	MJB9024D	MJB9024UD	\$3,213.00	565	
30	MJB9030D	MJB9030UD	\$6,909.00	930	
36	MJB9036D	MJB9036UD	\$10,772.00	1450	
42	MJB9042D	MJB9042UD	\$19,295.00	2205	
48	MJB9048D	MJB9048UD	\$25,729.00	2990	

**45° (1/8) MJ BEND**



3	MJB4503D	MJB4503UD	\$77.00	16	80
4	MJB4504D	MJB4504UD	\$77.00	22	80
6	MJB4506D	MJB4506UD	\$120.00	32	36
8	MJB4508D	MJB4508UD	\$170.00	46	27
10	MJB4510D	MJB4510UD	\$245.00	70	8
12	MJB4512D	MJB4512UD	\$426.00	86	8
14	MJB4514D	MJB4514UD	\$754.00	160	8
16	MJB4516D	MJB4516UD	\$941.00	202	4
18	MJB4518D	MJB4518UD	\$1,242.00	250	2
20	MJB4520D	MJB4520UD	\$1,467.00	305	
24	MJB4524D	MJB4524UD	\$2,126.00	405	
30	MJB4530D	MJB4530UD	\$5,481.00	780	
36	MJB4536D	MJB4536UD	\$8,433.00	1135	
42	MJB4542D	MJB4542UD	\$13,582.00	1610	
48	MJB4548D	MJB4548UD	\$17,795.00	2090	

**22 1/2° (1/16) MJ BEND**



3	MJB2203D	MJB2203UD	\$48.00	15	50
4	MJB2204D	MJB2204UD	\$74.00	18	100
6	MJB2206D	MJB2206UD	\$109.00	31	48
8	MJB2208D	MJB2208UD	\$166.00	46	36
10	MJB2210D	MJB2210UD	\$238.00	64	12
12	MJB2212D	MJB2212UD	\$361.00	80	12
14	MJB2214D	MJB2214UD	\$763.00	136	8
16	MJB2216D	MJB2216UD	\$903.00	172	4
18	MJB2218D	MJB2218UD	\$1,232.00	255	2
20	MJB2220D	MJB2220UD	\$1,557.00	310	2
24	MJB2224D	MJB2224UD	\$2,050.00	412	2
30	MJB2230D	MJB2230UD	\$4,683.00	665	
36	MJB2236D	MJB2236UD	\$7,132.00	960	
42	MJB2242D	MJB2242UD	\$11,079.00	1350	
48	MJB2248D	MJB2248UD	\$14,596.00	1760	



\*Weights exclude accessories



DOM-UPL.15.01

Size (inches)	Item Code Cement Lined w/ Black Coating	Item Code Bare In / Bare Out	Less Accessory List Price	Weight* (lbs.)	Crate Quantity
---------------	---	------------------------------	---------------------------	----------------	----------------

**11 1/4° (1/32) MJ BEND**



3	MJB1103D	MJB1103UD	\$48.00	14	30
4	MJB1104D	MJB1104UD	\$66.00	16	50
6	MJB1106D	MJB1106UD	\$112.00	30	60
8	MJB1108D	MJB1108UD	\$152.00	42	36
10	MJB1110D	MJB1110UD	\$248.00	58	12
12	MJB1112D	MJB1112UD	\$342.00	67	12
14	MJB1114D	MJB1114UD	\$783.00	93	8
16	MJB1116D	MJB1116UD	\$903.00	148	4
18	MJB1118D	MJB1118UD	\$1,355.00	205	2
20	MJB1120D	MJB1120UD	\$1,370.00	245	2
24	MJB1124D	MJB1124UD	\$1,887.00	315	2
30	MJB1130D	MJB1130UD	\$4,213.00	600	
36	MJB1136D	MJB1136UD	\$6,092.00	820	
42	MJB1142D	MJB1142UD	\$12,432.00	1180	
48	MJB1148D	MJB1148UD	\$12,755.00	1475	

**90° (1/4) MJ X PE BEND**

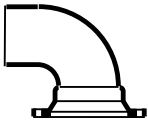

3	MJBP9003D	MJBP9003UD	\$71.00	16	80
4	MJBP9004D	MJBP9004UD	\$101.00	22	32
6	MJBP9006D	MJBP9006UD	\$145.00	41	24
8	MJBP9008D	MJBP9008UD	\$268.00	58	9
10	MJBP9010D	MJBP9010UD	\$447.00	83	4
12	MJBP9012D	MJBP9012UD	\$475.00	114	4
14	MJBP9014D	MJBP9014UD	\$946.00	197	
16	MJBP9016D	MJBP9016UD	\$1,449.00	248	2
20	MJBP9020D	MJBP9020UD	\$2,805.00	390	
24	MJBP9024D	MJBP9024UD	\$3,218.00	575	
30	MJBP9030D	MJBP9030UD	POA	865	

**45° (1/8) MJ X PE BEND**



3	MJBP4503D	MJBP4503UD	\$71.00	13	
4	MJBP4504D	MJBP4504UD	\$77.00	19	48
6	MJBP4506D	MJBP4506UD	\$124.00	34	24
8	MJBP4508D	MJBP4508UD	\$173.00	49	24
10	MJBP4510D	MJBP4510UD	\$331.00	69	12
12	MJBP4512D	MJBP4512UD	\$435.00	93	8
14	MJBP4514D	MJBP4514UD	\$701.00	146	
16	MJBP4516D	MJBP4516UD	\$884.00	184	2
20	MJBP4520D	MJBP4520UD	\$1,876.00	290	
24	MJBP4524D	MJBP4524UD	\$2,183.00	390	
30	MJBP4530D	MJBP4530UD	POA	715	

**22 1/2° (1/16) MJ X PE BEND**



3	MJBP2203D	MJBP2203UD	\$82.00	12	
4	MJBP2204D	MJBP2204UD	\$84.00	18	32
6	MJBP2206D	MJBP2206UD	\$117.00	29	20
8	MJBP2208D	MJBP2208UD	\$230.00	43	20
10	MJBP2210D	MJBP2210UD	\$274.00	61	18
12	MJBP2212D	MJBP2212UD	\$326.00	79	6
14	MJBP2214D	MJBP2214UD	\$730.00	133	



\*Weights exclude accessories



DOM-UPL.15.01

Size (inches)	Item Code Cement Lined w/ Black Coating	Item Code Bare In / Bare Out	Less Accessory List Price	Weight* (lbs.)	Crate Quantity
16	MJBP2216D	MJBP2216UD	\$1,224.00	166	
24	MJBP2224D	MJBP2224UD	\$2,211.00	395	
30	MJBP2230D	MJBP2230UD	POA	600	

**11 1/4° (1/32) MJ X PE BEND**



3	MJBP1103D	MJBP1103UD	\$63.00	12	40
4	MJBP1104D	MJBP1104UD	\$84.00	17	
6	MJBP1106D	MJBP1106UD	\$122.00	27	60
8	MJBP1108D	MJBP1108UD	\$184.00	39	36
10	MJBP1110D	MJBP1110UD	\$250.00	52	24
12	MJBP1112D	MJBP1112UD	\$329.00	69	16
14	MJBP1114D	MJBP1114UD	\$639.00	118	
16	MJBP1116D	MJBP1116UD	\$793.00	136	
24	MJBP1124D	MJBP1124UD	\$2,240.00	400	

**90° (1/4) MJ X FE BEND**

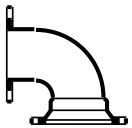

3	MJFB9003D	MJFB9003UD	\$88.00	20	32
4	MJFB9004D	MJFB9004UD	\$101.00	26	48
6	MJFB9006D	MJFB9006UD	\$170.00	47	27
8	MJFB9008D	MJFB9008UD	\$302.00	68	12
10	MJFB9010D	MJFB9010UD	\$470.00	102	8
12	MJFB9012D	MJFB9012UD	\$660.00	134	4
14	MJFB9014D	MJFB9014UD	\$1,320.00	227	
16	MJFB9016D	MJFB9016UD	\$1,609.00	306	

**45° (1/8) MJ X FE BEND**



4	MJFB4504D	MJFB4504UD	\$113.00	26	40
6	MJFB4506D	MJFB4506UD	\$195.00	47	12
8	MJFB4508D	MJFB4508UD	\$233.00	68	12
10	MJFB4510D	MJFB4510UD	\$341.00	102	4
12	MJFB4512D	MJFB4512UD	\$527.00	134	4
14	MJFB4514D	MJFB4514UD	\$1,286.00	207	
16	MJFB4516D	MJFB4516UD	\$1,535.00	239	

**22 1/2° (1/16) MJ X FE BEND**



4	MJFB2204D	MJFB2204UD	\$88.00	26	32
6	MJFB2206D	MJFB2206UD	\$133.00	47	48
8	MJFB2208D	MJFB2208UD	\$192.00	68	9
10	MJFB2210D	MJFB2210UD	\$375.00	102	4
12	MJFB2212D	MJFB2212UD	\$416.00	134	4

**11 1/4° (1/32) MJ X FE BEND**



4	MJFB1104D	MJFB1104UD	\$81.00	19	16
6	MJFB1106D	MJFB1106UD	\$125.00	30	18
8	MJFB1108D	MJFB1108UD	\$171.00	50	18
10	MJFB1110D	MJFB1110UD	\$312.00	75	
12	MJFB1112D	MJFB1112UD	\$366.00	88	6

**MJ LATERAL**

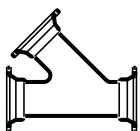

3x3	MJL0303D	MJL0303UD	\$139.00	36	30
4x3	MJL0403D	MJL0403UD	\$145.00	40	30
4x4	MJL0404D	MJL0404UD	\$191.00	51	30



\*Weights exclude accessories



DOM-UPL.15.01

Size (inches)	Item Code Cement Lined w/ Black Coating	Item Code Bare In / Bare Out	Less Accessory List Price	Weight* (lbs.)	Crate Quantity
6x4	MJL0604D	MJL0604UD	\$188.00	73	12
6x6	MJL0606D	MJL0606UD	\$278.00	81	6
8x4	MJL0804D	MJL0804UD	\$378.00	106	6
8x6	MJL0806D	MJL0806UD	\$453.00	114	6
8x8	MJL0808D	MJL0808UD	\$555.00	128	6
10x4	MJL1004D	MJL1004UD	\$497.00	150	4
10x6	MJL1006D	MJL1006UD	\$538.00	136	4
10x8	MJL1008D	MJL1008UD	\$673.00	170	4
10x10	MJL1010D	MJL1010UD	\$781.00	199	4
12x4	MJL1204D	MJL1204UD	\$739.00	184	2
12x6	MJL1206D	MJL1206UD	\$770.00	186	2
12x8	MJL1208D	MJL1208UD	\$803.00	188	2
12x10	MJL1210D	MJL1210UD	\$947.00	250	2
12x12	MJL1212D	MJL1212UD	\$1,054.00	272	2
14x06	MJL1406D	MJL1406UD	\$1,400.00	380	2
14x14	MJL1414D	MJL1414UD	\$2,285.00	474	2
16x6	MJL1606D	MJL1606UD	\$1,430.00	300	2
16x8	MJL1608D	MJL1608UD	\$1,675.00	349	2
16x12	MJL1612D	MJL1612UD	\$2,155.00	453	
16x16	MJL1616D	MJL1616UD	\$2,616.00	575	2

\*\*\* FULL BODY ONLY 18" AND HIGHER \*\*\*

**MJ X FE ADAPTER**

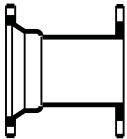

3	MJFA03D	MJFA03UD	\$65.00	14	75
4	MJFA04D	MJFA04UD	\$85.00	21	100
6	MJFA06D	MJFA06UD	\$116.00	28	45
8	MJFA08D	MJFA08UD	\$176.00	49	45
10	MJFA10D	MJFA10UD	\$315.00	60	20
12	MJFA12D	MJFA12UD	\$366.00	99	20
14	MJFA14D	MJFA14UD	\$663.00	150	8
16	MJFA16D	MJFA16UD	\$759.00	186	8
18	MJFA18D	MJFA18UD	\$1,124.00		
20	MJFA20D	MJFA20UD	\$1,344.00	252	2
24	MJFA24D	MJFA24UD	\$1,747.00		
30	MJFA30D	MJFA30UD	\$3,442.00	544	
36	MJFA36D	MJFA36UD	\$5,572.00	798	

**MJ TEE**

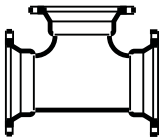

3x3	MJT0303D	MJT0303UD	\$118.00	28	50
4x3	MJT0403D	MJT0403UD	\$116.00	30	16
4x4	MJT0404D	MJT0404UD	\$123.00	32	32
6x3	MJT0603D	MJT0603UD	\$152.00	42	12
6x4	MJT0604D	MJT0604UD	\$188.00	46	24
6x6	MJT0606D	MJT0606UD	\$210.00	56	24
8x3	MJT0803D	MJT0803UD	\$210.00	52	9
8x4	MJT0804D	MJT0804UD	\$217.00	60	18
8x6	MJT0806D	MJT0806UD	\$263.00	72	18
8x8	MJT0808D	MJT0808UD	\$313.00	86	18
10x3	MJT1003D	MJT1003UD	\$333.00	75	6
10x4	MJT1004D	MJT1004UD	\$340.00	78	8
10x6	MJT1006D	MJT1006UD	\$410.00	90	8
10x8	MJT1008D	MJT1008UD	\$482.00	105	12
10x10	MJT1010D	MJT1010UD	\$547.00	120	4



\*Weights exclude accessories



# C153 Ductile Iron Compact Mechanical Joint Fittings

# Price List DOMESTIC - MJ COMPACT

DOM-UPL.15.01

Size (inches)	Item Code Cement Lined w/ Black Coating	Item Code Bare In / Bare Out	Less Accessory List Price	Weight* (lbs.)	Crate Quantity
12x3	MJT1203D	MJT1203UD	\$411.00	90	
12x4	MJT1204D	MJT1204UD	\$447.00	94	8
12x6	MJT1206D	MJT1206UD	\$495.00	110	8
12x8	MJT1208D	MJT1208UD	\$523.00	125	8
12x10	MJT1210D	MJT1210UD	\$659.00	140	4
12x12	MJT1212D	MJT1212UD	\$690.00	160	4
14x6	MJT1406D	MJT1406UD	\$875.00	182	4
14x8	MJT1408D	MJT1408UD	\$989.00	206	4
14x10	MJT1410D	MJT1410UD	\$1,094.00	228	4
14x12	MJT1412D	MJT1412UD	\$1,176.00	234	4
14x14	MJT1414D	MJT1414UD	\$1,344.00	280	4
16x6	MJT1606D	MJT1606UD	\$1,129.00	228	2
16x8	MJT1608D	MJT1608UD	\$1,224.00	248	2
16x10	MJT1610D	MJT1610UD	\$1,344.00	264	2
16x12	MJT1612D	MJT1612UD	\$1,465.00	280	2
16x14	MJT1614D	MJT1614UD	\$1,656.00	316	2
16x16	MJT1616D	MJT1616UD	\$1,848.00	322	2
18x6	MJT1806D	MJT1806UD	\$1,653.00	275	
18x8	MJT1808D	MJT1808UD	\$1,786.00	295	
18x10	MJT1810D	MJT1810UD	\$1,680.00	315	
18x12	MJT1812D	MJT1812UD	\$2,122.00	335	
18x14	MJT1814D	MJT1814UD	\$2,212.00	380	
18x16	MJT1816D	MJT1816UD	\$2,367.00	405	
18x18	MJT1818D	MJT1818UD	\$2,762.00	435	
20x6	MJT2006D	MJT2006UD	\$1,855.00	315	
20x8	MJT2008D	MJT2008UD	\$1,898.00	345	
20x10	MJT2010D	MJT2010UD	\$1,973.00	370	
20x12	MJT2012D	MJT2012UD	\$2,351.00	395	
20x14	MJT2014D	MJT2014UD	\$2,718.00	440	
20x16	MJT2016D	MJT2016UD	\$2,314.00	465	
20x18	MJT2018D	MJT2018UD	\$3,119.00	505	
20x20	MJT2020D	MJT2020UD	\$2,547.00	535	
24x6	MJT2406D	MJT2406UD	\$2,307.00	415	
24x8	MJT2408D	MJT2408UD	\$2,374.00	445	
24x10	MJT2410D	MJT2410UD	\$2,597.00	470	
24x12	MJT2412D	MJT2412UD	\$2,531.00	500	
24x14	MJT2414D	MJT2414UD	\$3,080.00	550	
24x16	MJT2416D	MJT2416UD	\$3,252.00	580	
24x18	MJT2418D	MJT2418UD	\$3,269.00	625	
24x20	MJT2420D	MJT2420UD	\$3,683.00	660	
24x24	MJT2424D	MJT2424UD	\$4,173.00	720	
30x6	MJT3006D	MJT3006UD	\$4,639.00	742	
30x8	MJT3008D	MJT3008UD	\$5,184.00	739	
30x12	MJT3012D	MJT3012UD	\$6,167.00	830	
30x16	MJT3016D	MJT3016UD	POA	959	
30x18	MJT3018D	MJT3018UD	POA	1085	
30x20	MJT3020D	MJT3020UD	\$7,533.00	995	
30x24	MJT3024D	MJT3024UD	\$7,883.00	1060	
30x30	MJT3030D	MJT3030UD	\$9,829.00	1323	
36x18	MJT3618D	MJT3618UD	\$19,388.00	1505	
36x24	MJT3624D	MJT3624UD	\$10,743.00	1498	
36x30	MJT3630D	MJT3630UD	POA	1555	
36x36	MJT3636D	MJT3636UD	\$14,746.00	1900	



\*Weights exclude accessories



DOM-UPL.15.01

Size (inches)	Item Code Cement Lined w/ Black Coating	Item Code Bare In / Bare Out	Less Accessory List Price	Weight* (lbs.)	Crate Quantity
42x24	MJT4224D	MJT4224UD	POA	2270	
42x30	MJT4230D	MJT4230UD	\$18,939.00	2425	
42x36	MJT4236D	MJT4236UD	\$24,214.00	3000	
42x42	MJT4242D	MJT4242UD	\$25,681.00	3175	
48x24	MJT4824D	MJT4824UD	POA	2870	
48x30	MJT4830D	MJT4830UD	POA	3050	
48x36	MJT4836D	MJT4836UD	\$32,269.00	3900	
48x42	MJT4842D	MJT4842UD	\$33,225.00	4100	
48x48	MJT4848D	MJT4848UD	\$34,449.00	4250	

**MJ X FE TEE**

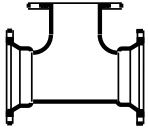

3x3	MJFT0303D	MJFT0303UD	\$120.00	30	40
4x3	MJFT0403D	MJFT0403UD	\$142.00	34	16
4x4	MJFT0404D	MJFT0404UD	\$162.00	40	36
6x3	MJFT0603D	MJFT0603UD	\$224.00	50	12
6x4	MJFT0604D	MJFT0604UD	\$233.00	55	24
6x6	MJFT0606D	MJFT0606UD	\$228.00	56	24
8x4	MJFT0804D	MJFT0804UD	\$268.00	75	18
8x6	MJFT0806D	MJFT0806UD	\$289.00	80	18
8x8	MJFT0808D	MJFT0808UD	\$418.00	85	12
10x4	MJFT1004D	MJFT1004UD	\$384.00	90	6
10x6	MJFT1006D	MJFT1006UD	\$482.00	100	8
10x8	MJFT1008D	MJFT1008UD	\$539.00	105	6
10x10	MJFT1010D	MJFT1010UD	\$615.00	125	4
12x4	MJFT1204D	MJFT1204UD	\$489.00	118	8
12x6	MJFT1206D	MJFT1206UD	\$492.00	120	8
12x8	MJFT1208D	MJFT1208UD	\$607.00	130	8
12x10	MJFT1210D	MJFT1210UD	\$722.00	150	4
12x12	MJFT1212D	MJFT1212UD	\$822.00	170	4
14x6	MJFT1406D	MJFT1406UD	\$969.00	205	4
14x10	MJFT1410D	MJFT1410UD	\$1,391.00	244	4
14x12	MJFT1412D	MJFT1412UD	\$1,513.00	284	4
14x14	MJFT1414D	MJFT1414UD	\$1,622.00	305	
16x6	MJFT1606D	MJFT1606UD	\$1,094.00	213	2
16x8	MJFT1608D	MJFT1608UD	\$1,325.00	260	2
16x10	MJFT1610D	MJFT1610UD	\$1,583.00	287	
16x12	MJFT1612D	MJFT1612UD	\$1,632.00	312	2
16x14	MJFT1614D	MJFT1614UD	\$1,714.00	348	
16x16	MJFT1616D	MJFT1616UD	\$2,255.00	374	2
18x6	MJFT1806D	MJFT1806UD	\$1,377.00	261	
18x8	MJFT1808D	MJFT1808UD	\$1,798.00	351	
20x6	MJFT2006D	MJFT2006UD	\$1,919.00	345	
24x6	MJFT2406D	MJFT2406UD	\$2,273.00	460	
24x12	MJFT2412D	MJFT2412UD	\$3,201.00	580	
24x16	MJFT2416D	MJFT2416UD	\$4,030.00	744	
36x6	MJFT3606D	MJFT3606UD	\$8,172.00	1175	

**MJ X PE X MJ TEE**

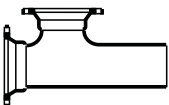

6	MJPT0606D	MJPT0606UD	\$243.00	57	
8x6	MJPT0806D	MJPT0806UD	\$336.00	69	
8	MJPT0808D	MJPT0808UD	\$355.00	78	9
10	MJPT1010D	MJPT1010UD	\$570.00	120	



\*Weights exclude accessories



DOM-UPL.15.01

Size (inches)	Item Code Cement Lined w/ Black Coating	Item Code Bare In / Bare Out	Less Accessory List Price	Weight* (lbs.)	Crate Quantity
---------------	---	------------------------------	---------------------------	----------------	----------------

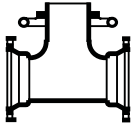

**MJ X SWIVEL HYDRANT TEE (W/SWIVEL GLAND)**

6x6	MJTH0606D	MJTH0606UD	\$242.00	65	24
8x6	MJTH0806D	MJTH0806UD	\$302.00	85	16
8x8	MJTH0808D	MJTH0808UD	\$436.00	100	16
10x6	MJTH1006D	MJTH1006UD	\$475.00	105	8
10x8	MJTH1008D	MJTH1008UD	\$573.00	118	4
12x6	MJTH1206D	MJTH1206UD	\$551.00	126	8
12x8	MJTH1208D	MJTH1208UD	\$620.00	128	4
14x6	MJTH1406D	MJTH1406UD	\$1,100.00	211	2
16x6	MJTH1606D	MJTH1606UD	\$985.00	279	2
18x6	MJTH1806D	MJTH1806UD	\$1,483.00	278	
20x6	MJTH2006D	MJTH2006UD	\$1,472.00	358	
24x6	MJTH2406D	MJTH2406UD	\$2,207.00	460	

**MJ TEE TAPPED (2" TAP)**

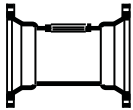

3	MJT0303TD	MJT0303TUD	\$124.00	18	50
4	MJT0404TD	MJT0404TUD	\$131.00	25	48
6	MJT0606TD	MJT0606TUD	\$169.00	35	9
8	MJT0808TD	MJT0808TUD	\$248.00	55	8
10	MJT1010TD	MJT1010TUD	\$321.00	70	6
12	MJT1212TD	MJT1212TUD	\$380.00	85	8
16	MJT1616TD	MJT1616TUD	\$916.00	164	

The standard tap size is 2" NPT. For other sizes, please contact Star® Pipe Products. Taps other than 2" NPT are special order, non-cancellable & non-refundable.

**MJ PLUG - SOLID**



3	MJP03D	MJP03UD	\$42.00	8	100
4	MJP04D	MJP04UD	\$55.00	10	100
6	MJP06D	MJP06UD	\$87.00	16	120
8	MJP08D	MJP08UD	\$124.00	26	99
10	MJP10D	MJP10UD	\$160.00	36	36
12	MJP12D	MJP12UD	\$191.00	46	40
14	MJP14D	MJP14UD	\$528.00	75	16
16	MJP16D	MJP16UD	\$678.00	95	10
18	MJP18D	MJP18UD	\$933.00	121	4
20	MJP20D	MJP20UD	\$1,141.00	135	4
24	MJP24D	MJP24UD	\$1,662.00	175	4
30	MJP30D	MJP30UD	\$4,027.00	355	
36	MJP36D	MJP36UD	\$6,227.00	688	
42	MJP42D	MJP42UD	\$8,198.00		
48	MJP48D	MJP48UD	\$10,937.00		

**MJ PLUG - TAPPED (2" TAP)**

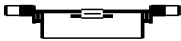

3	MJP03TD	MJP03TUD	\$77.00	8	100
4	MJP04TD	MJP04TUD	\$90.00	10	100
6	MJP06TD	MJP06TUD	\$123.00	20	120
8	MJP08TD	MJP08TUD	\$160.00	30	99
10	MJP10TD	MJP10TUD	\$194.00	40	36
12	MJP12TD	MJP12TUD	\$227.00	50	24
14	MJP14TD	MJP14TUD	\$600.00	77	16
16	MJP16TD	MJP16TUD	\$749.00	101	10
18	MJP18TD	MJP18TUD	\$1,004.00	130	4



\*Weights exclude accessories





DOM-UPL.15.01

Size (inches)	Item Code Cement Lined w/ Black Coating	Item Code Bare In / Bare Out	Less Accessory List Price	Weight* (lbs.)	Crate Quantity
20	MJP20TD	MJP20TUD	\$1,212.00	153	4
24	MJP24TD	MJP24TUD	\$1,733.00	202	4
30	MJP30TD	MJP30TUD	\$4,144.00	433	
36	MJP36TD	MJP36TUD	\$6,344.00	674	
42	MJP42TD	MJP42TUD	\$8,434.00		
48	MJP48TD	MJP48TUD	\$11,172.00		

The standard tap size is 2" NPT. For other sizes, please contact Star® Pipe Products. Taps other than 2" NPT are special order, non-cancellable & non-refundable.

**MJ SOLID SLEEVE SHORT**

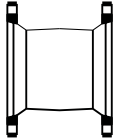

3	MJSS03D	MJSS03UD	\$54.00	12	48
4	MJSS04D	MJSS04UD	\$55.00	15	100
6	MJSS06D	MJSS06UD	\$91.00	23	48
8	MJSS08D	MJSS08UD	\$124.00	31	36
10	MJSS10D	MJSS10UD	\$188.00	45	12
12	MJSS12D	MJSS12UD	\$210.00	57	20
14	MJSS14D	MJSS14UD	\$519.00	94	6
16	MJSS16D	MJSS16UD	\$649.00	118	6
18	MJSS18D	MJSS18UD	\$848.00	145	2
20	MJSS20D	MJSS20UD	\$1,035.00	173	2
24	MJSS24D	MJSS24UD	\$1,423.00	226	2
30	MJSS30D	MJSS30UD	\$3,619.00	472	2
36	MJSS36D	MJSS36UD	\$4,918.00	673	

**MJ SOLID SLEEVE LONG**

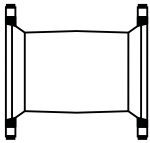

3	MJSL03D	MJSL03UD	\$74.00	17	50
4	MJSL04D	MJSL04UD	\$85.00	22	75
6	MJSL06D	MJSL06UD	\$127.00	29	48
8	MJSL08D	MJSL08UD	\$166.00	45	27
10	MJSL10D	MJSL10UD	\$249.00	61	27
12	MJSL12D	MJSL12UD	\$336.00	79	18
14	MJSL14D	MJSL14UD	\$669.00	128	8
16	MJSL16D	MJSL16UD	\$845.00	159	8
18	MJSL18D	MJSL18UD	\$1,120.00	200	2
20	MJSL20D	MJSL20UD	\$1,355.00	236	2
24	MJSL24D	MJSL24UD	\$1,870.00	306	2
30	MJSL30D	MJSL30UD	\$4,785.00	634	
36	MJSL36D	MJSL36UD	\$6,419.00	889	
42	MJSL42D	MJSL42UD	\$9,044.00	1165	
48	MJSL48D	MJSL48UD	\$11,225.00	1482	

**MJ CAP - SOLID**

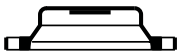

3	MJC03D	MJC03UD	\$42.00	8	100
4	MJC04D	MJC04UD	\$43.00	9	300
6	MJC06D	MJC06UD	\$58.00	15	132
8	MJC08D	MJC08UD	\$91.00	22	99
10	MJC10D	MJC10UD	\$133.00	32	54
12	MJC12D	MJC12UD	\$170.00	42	52
14	MJC14D	MJC14UD	\$352.00	66	16
16	MJC16D	MJC16UD	\$470.00	92	16
18	MJC18D	MJC18UD	\$641.00	114	8
20	MJC20D	MJC20UD	\$769.00	125	6



\*Weights exclude accessories



DOM-UPL.15.01

Size (inches)	Item Code Cement Lined w/ Black Coating	Item Code Bare In / Bare Out	Less Accessory List Price	Weight* (lbs.)	Crate Quantity
24	MJC24D	MJC24UD	\$1,110.00	166	6
30	MJC30D	MJC30UD	\$2,564.00	345	
36	MJC36D	MJC36UD	\$4,666.00	628	

**MJ CAP - TAPPED (2" TAP)**



3	MJC03TD	MJC03TUD	\$77.00	8	100
4	MJC04TD	MJC04TUD	\$78.00	12	300
6	MJC06TD	MJC06TUD	\$93.00	15	132
8	MJC08TD	MJC08TUD	\$126.00	25	99
10	MJC10TD	MJC10TUD	\$169.00	35	54
12	MJC12TD	MJC12TUD	\$205.00	45	52
14	MJC14TD	MJC14TUD	\$423.00	72	16
16	MJC16TD	MJC16TUD	\$542.00	98	20
18	MJC18TD	MJC18TUD	\$711.00	122	8
20	MJC20TD	MJC20TUD	\$839.00	148	8
24	MJC24TD	MJC24TUD	\$1,180.00	202	8
30	MJC30TD	MJC30TUD	\$2,682.00	385	
36	MJC36TD	MJC36TUD	\$4,784.00	614	

The standard tap size is 2" NPT. For other sizes, please contact Star® Pipe Products. Taps other than 2" NPT are special order, non-cancellable & non-refundable.

**MJ REDUCER**

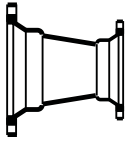

4x3	MJR0403D	MJR0403UD	\$70.00	18	80
6x3	MJR0603D	MJR0603UD	\$95.00	22	32
6x4	MJR0604D	MJR0604UD	\$84.00	24	64
8x4	MJR0804D	MJR0804UD	\$130.00	32	36
8x6	MJR0806D	MJR0806UD	\$140.00	36	36
10x4	MJR1004D	MJR1004UD	\$152.00	46	9
10x6	MJR1006D	MJR1006UD	\$152.00	47	27
10x8	MJR1008D	MJR1008UD	\$166.00	50	18
12x4	MJR1204D	MJR1204UD	\$279.00	58	4
12x6	MJR1206D	MJR1206UD	\$267.00	58	8
12x8	MJR1208D	MJR1208UD	\$273.00	57	12
12x10	MJR1210D	MJR1210UD	\$261.00	61	12
14x6	MJR1406D	MJR1406UD	\$528.00	100	4
14x8	MJR1408D	MJR1408UD	\$528.00	100	4
14x10	MJR1410D	MJR1410UD	\$480.00	100	4
14x12	MJR1412D	MJR1412UD	\$480.00	100	4
16x6	MJR1606D	MJR1606UD	\$697.00	124	4
16x8	MJR1608D	MJR1608UD	\$672.00	124	4
16x10	MJR1610D	MJR1610UD	\$649.00	124	4
16x12	MJR1612D	MJR1612UD	\$625.00	112	4
16x14	MJR1614D	MJR1614UD	\$793.00	140	4
18x8	MJR1808D	MJR1808UD	\$865.00	190	2
18x10	MJR1810D	MJR1810UD	\$987.00	195	2
18x12	MJR1812D	MJR1812UD	\$960.00	180	
18x14	MJR1814D	MJR1814UD	\$977.00	190	
18x16	MJR1816D	MJR1816UD	\$1,019.00	195	
20x10	MJR2010D	MJR2010UD	\$1,147.00	220	
20x12	MJR2012D	MJR2012UD	\$1,072.00	205	
20x14	MJR2014D	MJR2014UD	\$1,067.00	200	
20x16	MJR2016D	MJR2016UD	\$987.00	200	
20x18	MJR2018D	MJR2018UD	\$1,099.00	225	



\*Weights exclude accessories



DOM-UPL.15.01

Size (inches)	Item Code Cement Lined w/ Black Coating	Item Code Bare In / Bare Out	Less Accessory List Price	Weight* (lbs.)	Crate Quantity
24x12	MJR2412D	MJR2412UD	\$1,719.00	305	
24x14	MJR2414D	MJR2414UD	\$1,763.00	310	
24x16	MJR2416D	MJR2416UD	\$1,786.00	320	
24x18	MJR2418D	MJR2418UD	\$1,679.00	305	
24x20	MJR2420D	MJR2420UD	\$1,724.00	300	
30x24	MJR3024D	MJR3024UD	\$3,354.00	478	
36x24	MJR3624D	MJR3624UD	\$5,720.00	770	
36x30	MJR3630D	MJR3630UD	\$6,227.00	650	
42x24	MJR4224D	MJR4224UD	\$15,899.00		
42x30	MJR4230D	MJR4230UD	\$18,370.00		
42x36	MJR4236D	MJR4236UD	\$22,855.00		
48x24	MJR4824D	MJR4824UD	\$23,379.00		
48x30	MJR4830D	MJR4830UD	\$25,466.00		
48x36	MJR4836D	MJR4836UD	\$26,479.00		
48x42	MJR4842D	MJR4842UD	\$26,796.00		

**MJ SMALL END BELL (SEB) REDUCER**

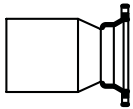

4x3	MJRS0403D	MJRS0403UD	\$70.00	17	32
6x3	MJRS0603D	MJRS0603UD	\$98.00	24	16
6x4	MJRS0604D	MJRS0604UD	\$95.00	25	50
8x4	MJRS0804D	MJRS0804UD	\$124.00	30	9
8x6	MJRS0806D	MJRS0806UD	\$127.00	35	24
10x4	MJRS1004D	MJRS1004UD	\$192.00	43	4
10x6	MJRS1006D	MJRS1006UD	\$166.00	46	4
10x8	MJRS1008D	MJRS1008UD	\$176.00	42	12
12x4	MJRS1204D	MJRS1204UD	\$254.00	60	4
12x6	MJRS1206D	MJRS1206UD	\$242.00	58	6
12x8	MJRS1208D	MJRS1208UD	\$258.00	54	6
12x10	MJRS1210D	MJRS1210UD	\$254.00	59	6
14x6	MJRS1406D	MJRS1406UD	\$515.00	100	
14x8	MJRS1408D	MJRS1408UD	\$515.00	98	
14x10	MJRS1410D	MJRS1410UD	\$453.00	94	4
14x12	MJRS1412D	MJRS1412UD	\$453.00	90	4
16x6	MJRS1606D	MJRS1606UD	\$669.00	125	4
16x8	MJRS1608D	MJRS1608UD	\$644.00	121	4
16x10	MJRS1610D	MJRS1610UD	\$634.00	105	4
16x12	MJRS1612D	MJRS1612UD	\$595.00	109	4
16x14	MJRS1614D	MJRS1614UD	\$605.00	126	4
18x8	MJRS1808D	MJRS1808UD	\$897.00	170	
18x10	MJRS1810D	MJRS1810UD	\$918.00	165	
18x12	MJRS1812D	MJRS1812UD	\$928.00	150	
18x14	MJRS1814D	MJRS1814UD	\$933.00	175	
18x16	MJRS1816D	MJRS1816UD	\$960.00	170	
20x10	MJRS2010D	MJRS2010UD	\$1,227.00	200	
20x12	MJRS2012D	MJRS2012UD	\$992.00	170	
20x14	MJRS2014D	MJRS2014UD	\$1,056.00	190	
20x16	MJRS2016D	MJRS2016UD	\$1,072.00	185	
20x18	MJRS2018D	MJRS2018UD	\$1,173.00	200	
24x12	MJRS2412D	MJRS2412UD	\$1,473.00	275	
24x14	MJRS2414D	MJRS2414UD	\$1,733.00	310	
24x16	MJRS2416D	MJRS2416UD	\$1,562.00	285	
24x18	MJRS2418D	MJRS2418UD	\$1,737.00	300	
24x20	MJRS2420D	MJRS2420UD	\$1,513.00	270	



\*Weights exclude accessories



DOM-UPL.15.01

Size (inches)	Item Code Cement Lined w/ Black Coating	Item Code Bare In / Bare Out	Less Accessory List Price	Weight* (lbs.)	Crate Quantity
36x16	MJRS3616D	MJRS3616UD	POA	620	
36x20	MJRS3620D	MJRS3620UD	POA	874	
36x24	MJRS3624D	MJRS3624UD	POA		

**MJ LARGE END BELL (LEB) REDUCER**

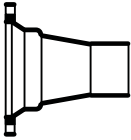

4x3	MJRL0403D	MJRL0403UD	\$70.00	18	40
6x3	MJRL0603D	MJRL0603UD	\$95.00	19	30
6x4	MJRL0604D	MJRL0604UD	\$109.00	25	30
8x4	MJRL0804D	MJRL0804UD	\$124.00	34	27
8x6	MJRL0806D	MJRL0806UD	\$133.00	32	27
10x4	MJRL1004D	MJRL1004UD	\$166.00	43	
10x6	MJRL1006D	MJRL1006UD	\$166.00	42	4
10x8	MJRL1008D	MJRL1008UD	\$182.00	50	4
12x4	MJRL1204D	MJRL1204UD	\$267.00	60	4
12x6	MJRL1206D	MJRL1206UD	\$263.00	58	4
12x8	MJRL1208D	MJRL1208UD	\$258.00	55	4
12x10	MJRL1210D	MJRL1210UD	\$263.00	59	4
14x6	MJRL1406D	MJRL1406UD	\$538.00	104	
14x8	MJRL1408D	MJRL1408UD	\$519.00	98	
14x10	MJRL1410D	MJRL1410UD	\$480.00	92	8
14x12	MJRL1412D	MJRL1412UD	\$701.00	92	
16x6	MJRL1606D	MJRL1606UD	\$759.00	136	4
16x8	MJRL1608D	MJRL1608UD	\$759.00	128	4
16x10	MJRL1610D	MJRL1610UD	\$727.00	123	4
16x12	MJRL1612D	MJRL1612UD	\$807.00	108	4
16x14	MJRL1614D	MJRL1614UD	\$855.00	132	4
18x8	MJRL1808D	MJRL1808UD	\$1,041.00	195	
18x10	MJRL1810D	MJRL1810UD	\$987.00	185	
18x12	MJRL1812D	MJRL1812UD	\$933.00	175	
18x14	MJRL1814D	MJRL1814UD	\$1,013.00	190	
18x16	MJRL1816D	MJRL1816UD	\$1,013.00	190	
20x10	MJRL2010D	MJRL2010UD	\$1,158.00	210	
20x12	MJRL2012D	MJRL2012UD	\$1,126.00	205	
20x14	MJRL2014D	MJRL2014UD	\$1,093.00	205	
20x16	MJRL2016D	MJRL2016UD	\$1,115.00	200	
24x12	MJRL2412D	MJRL2412UD	\$1,674.00	290	
24x14	MJRL2414D	MJRL2414UD	\$1,763.00	315	
24x16	MJRL2416D	MJRL2416UD	\$1,662.00	285	

**PE X PE REDUCER**



4x3	MJRP0403D	MJRP0403UD	\$66.00	14	30
6x3	MJRP0603D	MJRP0603UD	\$84.00	19	
6x4	MJRP0604D	MJRP0604UD	\$91.00	22	25
8x4	MJRP0804D	MJRP0804UD	\$120.00	30	16
8x6	MJRP0806D	MJRP0806UD	\$127.00	30	16
10x6	MJRP1006D	MJRP1006UD	\$206.00	46	9
10x8	MJRP1008D	MJRP1008UD	\$195.00	47	9
12x4	MJRP1204D	MJRP1204UD	\$250.00	58	9
12x6	MJRP1206D	MJRP1206UD	\$251.00	57	9
12x8	MJRP1208D	MJRP1208UD	\$250.00	54	9
12x10	MJRP1210D	MJRP1210UD	\$238.00	54	9
14x12	MJRP1412D	MJRP1412UD	\$443.00	88	
16x6	MJRP1606D	MJRP1606UD	\$639.00	93	



\*Weights exclude accessories



DOM-UPL.15.01

Size (inches)	Item Code Cement Lined w/ Black Coating	Item Code Bare In / Bare Out	Less Accessory List Price	Weight* (lbs.)	Crate Quantity
16x8	MJRP1608D	MJRP1608UD	\$639.00	119	
16x10	MJRP1610D	MJRP1610UD	\$621.00	119	
16x12	MJRP1612D	MJRP1612UD	\$605.00	99	
16x14	MJRP1614D	MJRP1614UD	\$639.00	129	

**MJ CROSS**

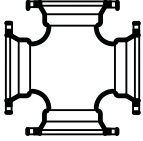

3x3	MJX0303D	MJX0303UD	\$129.00	35	12
4x3	MJX0403D	MJX0403UD	\$165.00	49	12
4x4	MJX0404D	MJX0404UD	\$195.00	40	12
6x4	MJX0604D	MJX0604UD	\$259.00	70	6
6x6	MJX0606D	MJX0606UD	\$329.00	75	12
8x4	MJX0804D	MJX0804UD	\$350.00	97	6
8x6	MJX0806D	MJX0806UD	\$406.00	103	12
8x8	MJX0808D	MJX0808UD	\$464.00	105	12
10x4	MJX1004D	MJX1004UD	\$407.00	120	4
10x6	MJX1006D	MJX1006UD	\$502.00	125	4
10x8	MJX1008D	MJX1008UD	\$563.00	130	8
10x10	MJX1010D	MJX1010UD	\$647.00	145	8
12x4	MJX1204D	MJX1204UD	\$496.00	123	4
12x6	MJX1206D	MJX1206UD	\$572.00	159	8
12x8	MJX1208D	MJX1208UD	\$616.00	165	8
12x10	MJX1210D	MJX1210UD	\$777.00	187	4
12x12	MJX1212D	MJX1212UD	\$839.00	213	4
14x6	MJX1406D	MJX1406UD	\$999.00	210	2
14x8	MJX1408D	MJX1408UD	\$1,200.00	231	
14x10	MJX1410D	MJX1410UD	\$1,224.00	255	
14x12	MJX1412D	MJX1412UD	\$1,292.00	269	
14x14	MJX1414D	MJX1414UD	\$1,435.00	299	4
16x6	MJX1606D	MJX1606UD	\$1,200.00	250	2
16x8	MJX1608D	MJX1608UD	\$1,388.00	264	2
16x10	MJX1610D	MJX1610UD	\$1,656.00	286	
16x12	MJX1612D	MJX1612UD	\$1,906.00	310	2
16x14	MJX1614D	MJX1614UD	POA	395	2
16x16	MJX1616D	MJX1616UD	\$2,773.00		
24x24	MJX2424D	MJX2424UD	\$6,474.00	1038	
30x20	MJX3020D	MJX3020UD	POA		
30x24	MJX3024D	MJX3024UD	POA	1640	
30x30	MJX3030D	MJX3030UD	POA	1840	
36x24	MJX3624D	MJX3624UD	\$23,704.00	1955	
36x30	MJX3630D	MJX3630UD	POA		
36x36	MJX3636D	MJX3636UD	\$19,723.00	2655	
42x24	MJX4224D	MJX4224UD	POA		
42x30	MJX4230D	MJX4230UD	POA		
42x36	MJX4236D	MJX4236UD	POA	3375	
42x42	MJX4242D	MJX4242UD	POA		
48x24	MJX4824D	MJX4824UD	POA	3670	
48x30	MJX4830D	MJX4830UD	POA	4506	
48x36	MJX4836D	MJX4836UD	POA	4700	
48x42	MJX4842D	MJX4832UD	POA		
48x48	MJX4848D	MJX4836UD	POA		



\*Weights exclude accessories



DOM-UPL.15.01

Size (inches)	Item Code Cement Lined w/ Black Coating	Item Code Bare In / Bare Out	Less Accessory List Price	Weight* (lbs.)	Crate Quantity
---------------	---	------------------------------	---------------------------	----------------	----------------

**MJ SWIVEL X SOLID HYDRANT ADAPTER (W/ SWIVEL GLAND)**

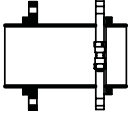

6x13	MJHA0613D	MJHA0613UD	\$170.00	47	36
6x18	MJHA0618D	MJHA0618UD	\$210.00	56	12
6x24	MJHA0624D	MJHA0624UD	\$249.00	60	16
8x13	MJHA0813D	MJHA0813UD	\$253.00	54	18

**SWIVEL x SWIVEL HYDRANT ADAPTER (WITH 2 SWIVEL GLANDS)**

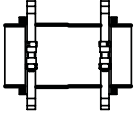

6x12	HHA0612D	HHA0612UD	\$166.00	28	
6x18	HHA0618D	HHA0618UD	\$242.00	49	
6x24	HHA0624D	HHA0624UD	\$245.00	52	



\*Weights exclude accessories