



PVC Stargrip® series 4000

Mechanical Joint Wedge Action Restraint
for AWWA C900/C905 and IPS PVC Pipe



SUBMITTAL INFORMATION

PROJECT NAME:

ENGINEER:

CONTRACTOR:

SPEC. SECTION:



FEATURES & ADVANTAGES

- The design eliminates tie rods and thrust blocks and has been proven in the market since 1992.
- Can be used on 4"-12" AWWA C900, 14"-36" AWWA C905 PVC pipe or 3"-12" IPS PVC pipe* (***transition gasket required on IPS PVC Pipe 12" and under**).
- Listed with Underwriters Laboratories in sizes 4"-12" for use on DR18 class 235 C900 PVC pipe at 150 PSI. Approved by Factory Mutual Research in sizes 4"-12" for use on DR18 class 235 at 150 PSI and for sizes 4"-10" DR14 class 305 C900 PVC pipe at 200 PSI.
- Tested to and meets the requirements of ASTM F1674 through 14" size for DR18 PVC pipe.
- The safety factor is twice (2:1) the standardized pressure rating listed on Page 18.
- Double headed torque limiting bolts utilize 1 1/4" wrench size on both hex heads.
- Will fit any Mechanical Joint configuration, meaning compatibility with different types of installations.
- PVC Stargrip® offers 5° deflection through 12", 3° on 14"-24" and 2° on 30"-36".
- Larger ID allows easier installation on out-of-round pipe.
- Torque limiting bolts are designed with collars so that a wrench won't slip off the bottom for easier installation and so you won't over torque and damage PVC pipe.
- All sizes have curved wedges that will not flatten pipe.
- For use on HDPE or C909 pipe, please contact Star Engineering.

MATERIAL SPECIFICATIONS:

- Gland: Ductile Iron per ASTM A536, Grade 65-45-12
- Wedges: Ductile Iron per ASTM A536, Grade 65-45-12 heat treated to a minimum of 370 BHN
 - ♦ Wedge Finish: Fluorocarbon Star-Blue resin bonded coating, thermally cured dry lubricant

GLAND FINISH OPTIONS (Please check one):

Standard: Star Multi-Coat™ 2-phase coating process consisting of a zinc rich primer base coat and an alkyl enamel top coating

Optional: Starbond™ TGIC polyester powder coating applied by an electrostatic spray process

Optional: Other (specify) _____

HARDWARE OPTIONS (Please check):

Standard: T-bolts are high strength low alloy steel manufactured in accordance with ANSI/AWWA C111/A21.11-00

Optional: T-bolts and nuts alloy SS 304 per ASTM F593

Optional: T-bolts and nuts alloy SS 316 per ASTM F593

Optional: T-bolts and nuts Fluoropolymer Star-Blue coated high strength low alloy steel manufactured in accordance with ANSI/AWWA C111/A21.11-00

COUNTRY OF ORIGIN OPTION (Please check one):

Import

Domestic



STAR® PIPE PRODUCTS



PVC Stargrip® series 4000

Mechanical Joint Wedge Action Restraint for AWWA C900/C905 and IPS PVC Pipe

TECHNICAL INFORMATION

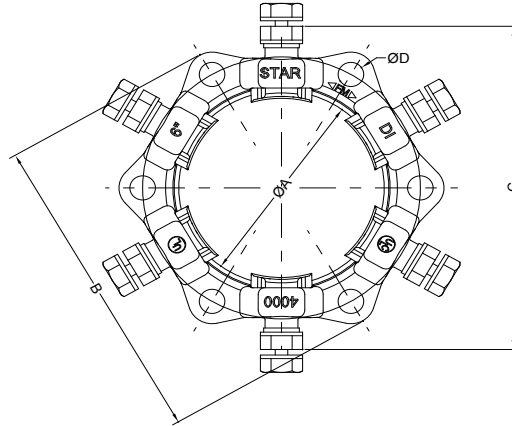

Please check sizes:

PVC STARGRIP® 4000 SPECIFICATIONS*									
NOM. SIZE	C900/C905 PIPE CI OD	IPS PIPE OD (TRANSITION GASKET REQUIRED)	ØA	B	C¹	ØD	T-BOLTS SIZE (QTY)	WEDGES (QTY)	APPROX WT. (LBS)
3	N/A	3.50	4.09	7.69	8.50	3/4	5/8 (4)	4	7
4	4.80	4.50	4.93	9.12	9.53	7/8	3/4 (4)	4	9
6	6.90	6.63	7.03	11.12	11.63	7/8	3/4 (6)	6	13
8	9.05	8.63	9.18	13.37	13.97	7/8	3/4 (6)	6	17
10	11.10	10.75	11.23	15.62	16.18	7/8	3/4 (8)	8	23
12	13.20	12.75	13.33	17.87	18.18	7/8	3/4 (8)	8	28
14	15.30	N/A	15.45	20.75	20.36	7/8	3/4 (10)	10	50
16	17.40	N/A	17.55	23.00	22.46	7/8	3/4 (12)	12	60
18	19.50	N/A	19.65	25.25	24.56	7/8	3/4 (12)	12	65
20	21.60	N/A	21.75	27.50	26.66	7/8	3/4 (14)	14	76
24	25.80	N/A	25.95	32.00	30.86	7/8	3/4 (16)	16	98
30	32.00	N/A	32.18	39.38	36.82	1-1/8	1 (20)	20	173
36	38.30	N/A	38.48	46.25	43.12	1-1/8	1 (24)	24	219

*All dimensions in inches except where indicated.
 1 - dimension after assembly on pipe

NOM. SIZE (IN)	C900			C905				ASTM D2241		
	DR14	DR18	DR25	DR18	DR21	DR25	DR32.5	SDR17	SDR21	SDR26
3								250	200	160
4	305	235	165					250	200	160
6	305	235	165					250	200	160
8	305	235	165					250	200	160
10	305	235	165					250	200	160
12	305	235	165					250	200	160
14				235	200	165	125			
16				235	200	165	125			
18				200	200	165	125			
20				200	200	165	125			
24				165	165	165	125			
30						165	125			
36						165	125			

STAR® PIPE PRODUCTS

