

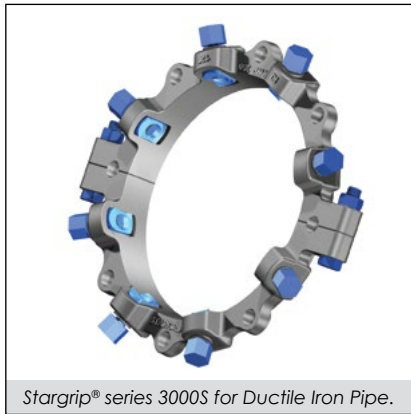

# Split Stargrip® series 3000S

Split Mechanical Joint Wedge Action Restraint  
for New or Existing Ductile Iron Pipe



Stargrip® series 3000S for Ductile Iron Pipe.

### SUBMITTAL INFORMATION

PROJECT NAME:

ENGINEER:

CONTRACTOR:

SPEC. SECTION:



### FEATURES & ADVANTAGES

- Split design Stargrip® Series 3000S for easy installation on new or existing Ductile Iron Mechanical Joint systems.
- The Wedge Assembly is designed with a Break-Off Torque Control Nut that will only break off in one direction, ensuring proper installation.
- Offers a full 5° deflection through 12" size, 3° on 14"-24", 2° on 30"-36" and 1° on 42"-48".
- Minimum safety factor of 2:1
- The Wedge Assembly is designed to fit specific pipe sizes and is field repairable.
- Clamping bolts per SAE J429 Grade 5 steel
- Eliminates tie rods and thrust blocks
- Split Stargrip® may also be used on steel pipe\* up to 12" (**\*transition gasket required on 12" and under**). For 14" and larger steel applications, contact Star Pipe.

### MATERIAL SPECIFICATIONS:

- Gland: Ductile Iron per ASTM A536, Grade 65-45-12
- Wedges: Ductile Iron per ASTM A536, Grade 65-45-12 heat treated to a minimum of 370 BHN
  - ◆ Wedge Finish: Thermally cured fluoropolymer epoxy coating

### GLAND FINISH OPTIONS (Please check one):

- Standard: alkyd enamel coating
- Optional: Starbond™ TGIC polyester powder coating applied by an electrostatic spray process
- Optional: Other (specify) \_\_\_\_\_

### HARDWARE OPTIONS (Please check):

- Standard: T-bolts are high strength low alloy steel manufactured in accordance with ANSI/AWWA C111/A21.11-00
- Optional: T-bolts and nuts alloy SS 304 per ASTM F593
- Optional: T-bolts and nuts alloy SS 316 per ASTM F593
- Optional: T-bolts and nuts Fluoropolymer Star-Blue coated high strength low alloy steel manufactured in accordance with ANSI/AWWA C111/A21.11-00

STAR® PIPE PRODUCTS





# Split Stargrip® series 3000S

Split Mechanical Joint Wedge Action Restraint  
for Ductile Iron Pipe

TECHNICAL INFORMATION

STAR® PIPE PRODUCTS

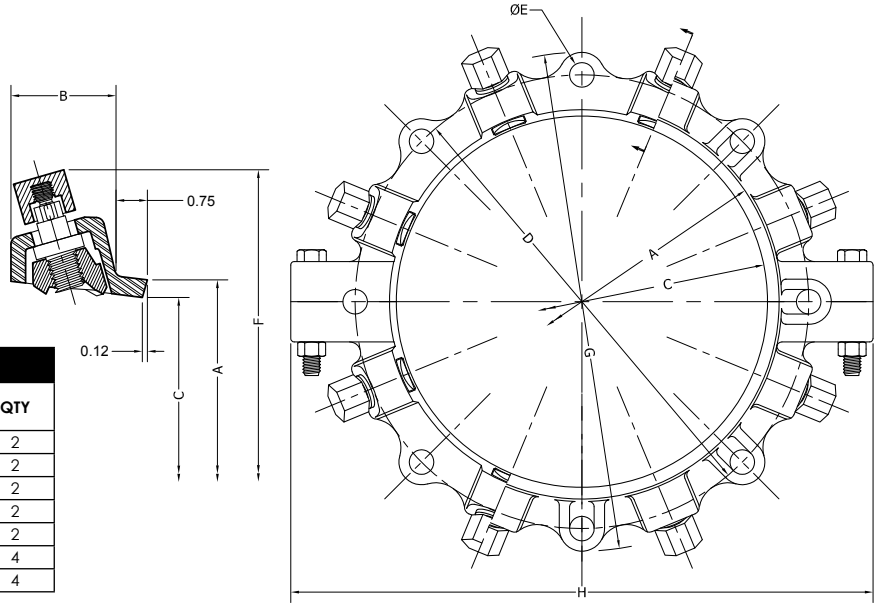

| CLAMPING BOLT SIZE |                |     |
|--------------------|----------------|-----|
| SERIES 3000S (IN)  | BOLT SIZE (IN) | QTY |
| 3-6                | 5/8 x 3 1/2    | 2   |
| 8-10               | 3/4 x 3 1/2    | 2   |
| 12                 | 3/4 x 4        | 2   |
| 14-24              | 7/8 x 3 3/4    | 2   |
| 30                 | 1 x 3 3/4      | 2   |
| 36                 | 7/8 x 3 3/4    | 4   |
| 42-48              | 1 1/8 x 4 1/2  | 4   |

SPLIT STARGRIP® 3000S SPECIFICATIONS\*

Please check sizes:

| NOM. SIZE | MAX PRESSURE RATING (PSI) | A     | B    | C     | D     | E     | F     | F W/ NUTS TWISTED OFF | G     | H     | WEDGES (QTY) | T-BOLTS (QTY) | APPROX WT. (LBS) |
|-----------|---------------------------|-------|------|-------|-------|-------|-------|-----------------------|-------|-------|--------------|---------------|------------------|
| 3         | 350                       | 4.66  | 2.40 | 4.06  | 6.19  | 3/4   | 9.85  | 8.45                  | 7.69  | 8.77  | 2            | 4             | 9                |
| 4         | 350                       | 5.92  | 2.44 | 4.90  | 7.50  | 7/8   | 11.06 | 9.28                  | 9.12  | 9.80  | 2            | 4             | 11               |
| 6         | 350                       | 8.02  | 2.44 | 7.00  | 9.50  | 7/8   | 13.06 | 11.38                 | 11.12 | 13.86 | 3            | 6             | 14               |
| 8         | 350                       | 10.17 | 2.44 | 9.15  | 11.75 | 7/8   | 15.25 | 13.53                 | 13.37 | 15.16 | 4            | 6             | 17               |
| 10        | 300                       | 12.22 | 2.44 | 11.20 | 14.00 | 7/8   | 17.25 | 15.58                 | 15.62 | 17.98 | 6            | 8             | 26               |
| 12        | 300                       | 14.32 | 2.44 | 13.30 | 16.25 | 7/8   | 19.50 | 12.68                 | 17.88 | 20.86 | 8            | 8             | 36               |
| 14        | 300                       | 16.40 | 2.83 | 15.44 | 18.75 | 7/8   | 21.25 | 19.82                 | 20.75 | 25.08 | 10           | 10            | 49               |
| 16        | 300                       | 18.50 | 2.83 | 17.54 | 21.00 | 7/8   | 23.34 | 21.92                 | 23.00 | 27.12 | 12           | 12            | 56               |
| 18        | 200                       | 20.60 | 2.91 | 19.64 | 23.25 | 7/8   | 26.40 | 24.84                 | 25.25 | 29.64 | 12           | 12            | 61               |
| 20        | 200                       | 22.70 | 2.67 | 21.74 | 25.50 | 7/8   | 28.56 | 27.00                 | 27.50 | 31.66 | 14           | 14            | 75               |
| 24        | 200                       | 26.90 | 3.50 | 25.94 | 30.00 | 7/8   | 33.86 | 32.30                 | 31.54 | 36.14 | 16           | 16            | 134              |
| 30        | 200                       | 33.29 | 3.49 | 32.17 | 36.88 | 1 1/8 | 40.12 | 38.56                 | 39.12 | 44.18 | 20           | 20            | 201              |
| 36        | 200                       | 39.59 | 3.49 | 38.47 | 43.75 | 1 1/8 | 46.42 | 44.86                 | 46.00 | 51.29 | 24           | 24            | 240              |
| 42        | 175                       | 45.79 | 5.15 | 44.75 | 50.62 | 1 3/8 | 54.86 | 53.32                 | 53.12 | 58.82 | 28           | 28            | 581              |
| 48        | 175                       | 52.09 | 5.15 | 51.05 | 57.50 | 1 3/8 | 61.16 | 59.62                 | 60.00 | 65.12 | 32           | 32            | 664              |

\*All dimensions in inches except where indicated.

Notes:

- Sizes 42" & 48" require extra long 1 1/4" x 8 1/2" T-bolts.
- For applications with vertical offsets please contact Star Pipe Products for technical assistance.
- Pressure ratings shall not exceed the maximum pressure rating of the ductile iron pipe it is installed on.